

LEGEND

○ = Corner having information on form 7100-52 in this file.

Ledgend conforms to Reporting forms MPMCC 10/79

FILING INSTRUCTION

File 7100-52 card record by letter and number coordinates behind the file guide for the township in which it falls. *SFNF 1984*

File the 7100-52 card record by letter and then by number i.e., all A cards first, then B cards etc.

The first card behind the file guide (if data have been obtained and recorded) will be card A-1 for N.W. Township Corner, then card A-2 for 1/16 corner then card A-3 for 1/4 corner etc.

D-7100-52 d (10/78)
USDA-FOREST SERVICE

Index
File No. 0125

CORNER RECORD (SEARCH)
(Ref. FSM 7151.4)

Contract or
Survey No. _____

Cor.
No. A-01

T 17 S. R. 10 E. R.D.

SISTEAS

County

DESCHUTES

NW

Cor. of

Merid. WILLAMETTE

N.F.

DESCHUTES

State

OREGON

Section

6

SEE: 2-01 T. 16 S., R. 10 E. W.M.

2-BCSP



D-7100-52d (10/78)
USDA-FOREST SERVICE

Index
File No. 0951

CORNER RECORD (SEARCH) Contract or
(Ref. FSM 7151.4) Survey No. _____ Cor. No. A-09

T 17 S. R. 10 E. R.D. Sisters County Deschutes NW Cor. of
Merid. WILLAMETTE N.F. DESCHUTES State OREGON Section 4

SEE: 2-09 T. 16 S., R. 10 E., W.M.

Alum-CAP SET

12/86

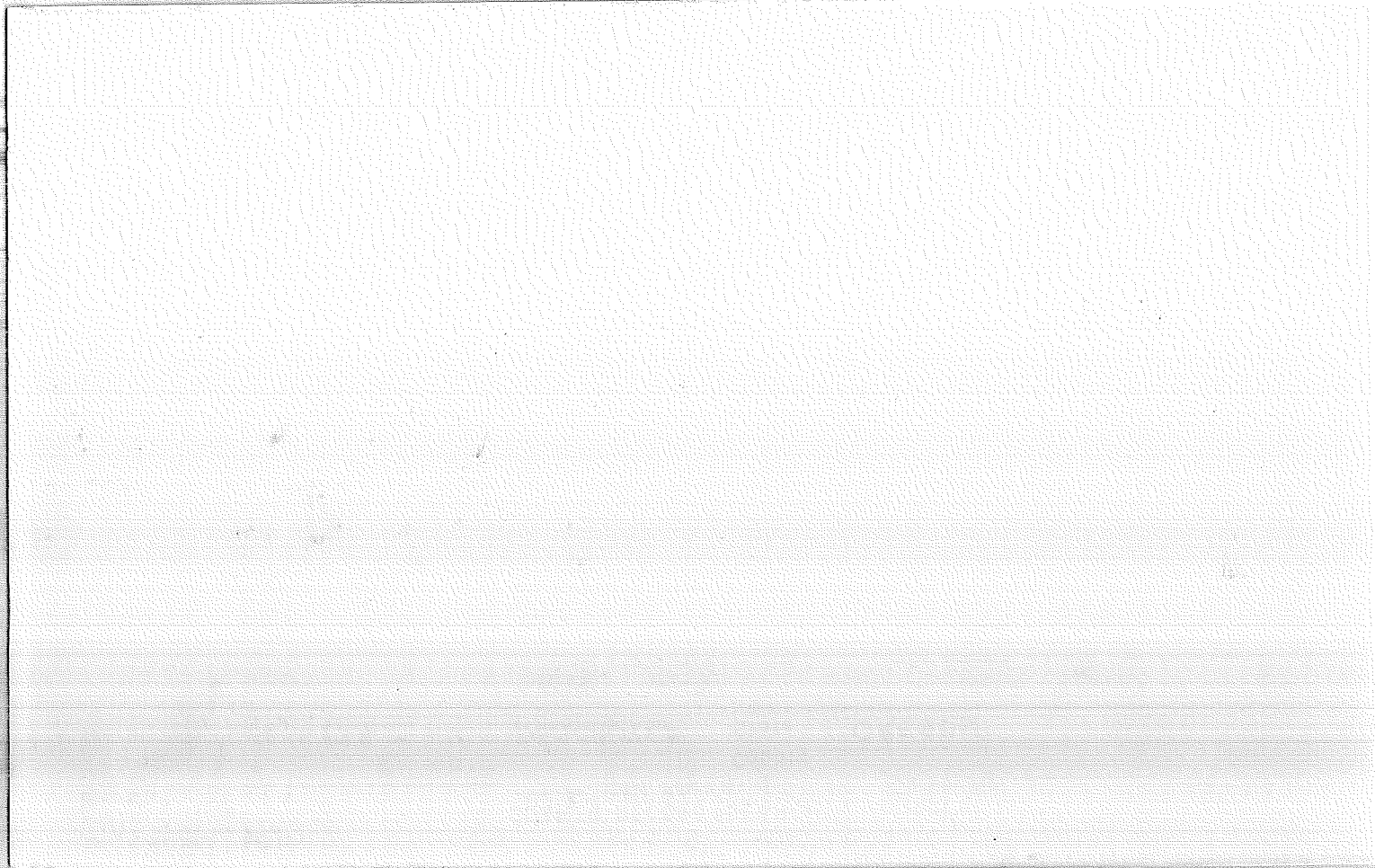

Index File No. A-13 1351

CORNER RECORD (SEARCH)

Tract or Survey No. _____

Cor. No. A-13

T 17S R. 10E

R.D. SISTERS County DESCHUTES

SEC COIR

Merid. Will

N.F. DESCHUTES State OREGON

CORNER DIAGRAM

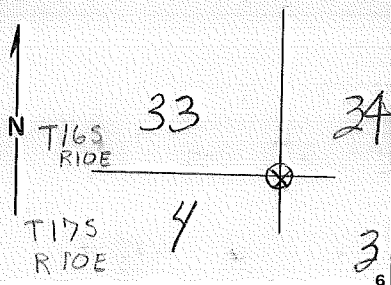

DESCRIBE CORNER MONUMENT FOUND

STONE IN PLACE 15"x6"x8" SCRIBED ON E FACE

DESCRIBE BEARING TREES OR OTHER OFFICIAL ACCESSORIES FOUND

BT=24" P. Pine, bears N79°W, 20' dist
BT=21" P. Pine, bears N40°E, 19' dist.

PHOTO IDENTIFICATION DATA

Photo No. _____
Filed At. _____
Object Ident. _____
Ident. By _____
Signature _____

DESCRIBE CORNER LOCATION RELATIVE TO NEAR-BY FEATURES, ALSO HOW TO REACH CORNER

Sec. line marker between secs 3&4 is on a tree on the Blakely road, located 600' S. of corner. Corner is on E side of ridge the runs NE&SW

PLANE COORDINATE POSITION DATA

State _____ Zone _____
X _____
Y _____
Estab. By _____
Agency _____

Signature

O.A.J. Thingvall

Title

Fovester

Division

Headquarters

Date

6-2-60

7100-52

REV. 65 5

CORNER RECORD (PERPETUATION)

MONUMENT: DESCRIBE NEW MONUMENT SET, OR WORK DONE TO PRESERVE EXISTING MONUMENT

9

ACCESSORIES DESCRIBE NEW BT'S WITNESS OBJECTS ETC. ESTABLISHED, OR WORK DONE TO PRESERVE EXISTING EVIDENCE

10

Work Done By _____ Title _____ Date _____ State Registration No. or Agency _____

Certified Cor. Record Prepared? Yes No Filed At: _____ Date _____

11

REMARKS

12

Index File No. 1351 T. 17S. R. 10 EW M.

Tract or Surv. No.

Cor. 2-13 13

Index
File No. 2551
T 17 S. R. 10E. R.D. SISTERS County DESCHUTES Tract or Survey No. A-25
Merid. WILLAMETTE N.F. DESCHUTES State OREGON NE COR. SEC. 1
SW COR. SEC. 31

SEE: Z-25
T 16 S R 10 E

EC
By BLM

A-25

USDA-FOREST SERVICE D-7100-52(2/82)

Index

File No. 0153

T 17 S. R. 10 E.

Merid. Willamette

CORNER RECORD (SEARCH) Contract or
(Ref. FSM 7151.4) Survey No.

R.D. SISTERS

County DESCHUTES

Cor. No. C-01

N.F. Deschutes

State Oregon

Section 6

CORNER DIAGRAM per legend

DESCRIBE CORNER MONUMENT FOUND

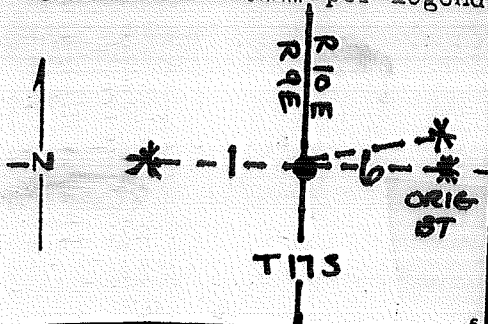

SF/NF

DESCRIBE BEARING TREES OR OTHER OFFICIAL ACCESSORIES FOUND

Found 11" diameter stump, 5 Ft. high and broken off with a scribed BT. There was a matching root wad adjacent to stump.

PHOTO IDENTIFICATION DATA

Photo No.

Filed At.

Object Ident.

Ident. By

Signature

DESCRIBE CORNER LOCATION RELATIVE TO NEAR-BY FEATURES, ALSO HOW TO REACH CORNER

CORNER LEGEND:

FS or Unverified

Contr. Other



◇ Searched For/Not Found



⊗ Evidence Found/Accept.



◆ Permanent Mon. Set/Td.

Searched By:

W. Miller

Title

PLS

Division

CS

Headquarters

Jo

Date

1985

CORNER RECORD (PERPETUATION)

MONUMENT. DESCRIBE NEW MONUMENT SET, OR WORK DONE TO PRESERVE EXISTING MONUMENT

Set 2 1/2" X 30" Brass-Capped Steel Pipe rising 7" in a stone mound. Set corner from Bearing and distance from Remaining BT.

MONUMENT STAMPED

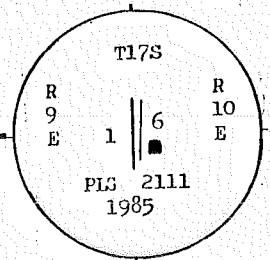

9

ACCESSORIES DESCRIBE NEW BT'S WITNESS OBJECTS ETC. ESTABLISHED, OR WORK DONE TO PRESERVE EXISTING EVIDENCE

- 1) A 7" white Fir bears N 74 1/2° E at 45.52 Ft. to a 60d spike in the NNW base, mkd. W/436BT.
- 2) A 10" white Fir bears S 82° W at 42.52 Ft. to a 60d spike in the SSE base, mkd. E/4S1BT.

10

Work Done By W. Miller Title PLS Date _____ State Registration No or Agency 2111

Plat DE for Record Prepared? Yes No Filed At Des. Co. Surveyor's Office Date 6/21/85

History of Surveys, G.L.O., etc. Set post for 1/4 Sec. corner, from which:
 - A pine 6 in diam bears N 78° E 63 lks dist
 - A pine 10 " " " S 75° W 20 " "

12

Index File No. T. S., R. E., W.M. Contract or Surv. No Cor.

0153 17 10 C-01

Index File No. 0953

CORNER RECORD (SEARCH). Contract or Survey No. _____
 (Ref. FSM 7151.4)

Cor. No. C-09

T 17 S. R. 10 E. R.D. BEND

County DESCHUTES

W/4

Cor. of _____

Merid. Willamette

N.F. Deschutes

State Oregon

Section 4

CORNER DIAGRAM per legend

DESCRIBE CORNER MONUMENT FOUND

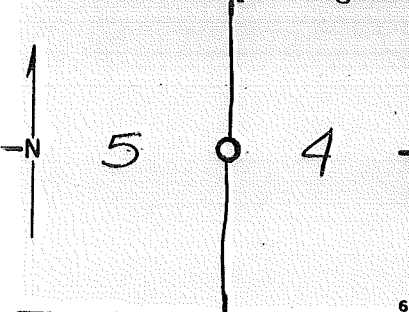

S.F.N.F.

DESCRIBE BEARING TREES OR OTHER OFFICIAL ACCESSORIES FOUND

FALLS IN CLEAR CUT w/SLASH PILES

NO SIGN OF ANYTHING

PHOTO IDENTIFICATION DATA

Photo No. _____
 Filed At. _____
 Object Ident. _____
 Ident. By _____
 Signature _____

DESCRIBE CORNER LOCATION RELATIVE TO NEAR-BY FEATURES, ALSO HOW TO REACH CORNER

999' SOUTH OF SIGN BOARD

CORNER LEGEND:

- | | |
|-------------------------------------|--|
| FS or | Unverified |
| Contr. | Other |
| <input type="checkbox"/> | <input type="checkbox"/> Searched For/Not Found |
| <input checked="" type="checkbox"/> | <input checked="" type="checkbox"/> Evidence Found/Accept. |
| <input checked="" type="checkbox"/> | <input checked="" type="checkbox"/> Permanent Mon. Set/Fd. |

Searched By: S. CHAMBERLAIN

Title

S.T.

Division

CS

Headquarters

SO

Date 6-14-84

CORNER RECORD (PERPETUATION)

MONUMENTS : DESCRIBE NEW MONUMENT SET, OR WORK DONE TO PRESERVE EXISTING MONUMENT

MONUMENT STAMPED

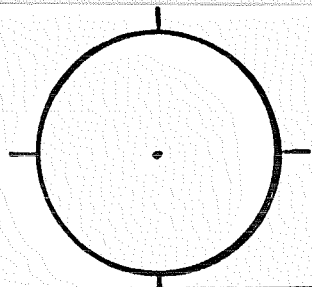

ACCESSORIES : DESCRIBE NEW BT'S WITNESS OBJECTS ETC. ESTABLISHED, OR WORK DONE TO PRESERVE EXISTING EVIDENCE

Work Done By _____ Title _____ Date _____ State Registration No. _____
or Agency _____
Plat or Certified Cor. Record Prepared? Yes No Filed At: _____ Co. Surveyor's Office Date _____

History of Surveys, G.L.O., etc.
8" PINE N 73° W @ 36²
8" " S 65° E @ 14⁵

Index File No. 0953 T. 17 S., R. 10 E., W.M. Contract or Surv. No. Cor. C-09

D-7100-52d (10/78)
USDA-FOREST SERVICE

Index

File No. 2553

CORNER RECORD (SEARCH)

(Ref. FSM 7151.4)

Tract or

Survey No.

Cor.

No.

C-25

T 17 S. R. 10 E.

R.D.

SISTERS

County

DESCHUTES

E/4 Cor Sec 1

Merid. WILLAMETTE

N.F.

DESCHUTES

State

OREGON

W/4 Cor Sec 6

SEE: C-01 T17S R11E

SF/DF

C-25

D-7100-52d (10/78)
USDA-FOREST SERVICE

Index File No. 2554 CORNER RECORD (SEARCH) Tract or Survey No. Cor. No. D-25
(Ref. FSM 7151.4)
T 17 S. R. 10 E. R.D. SISTERS County DESCHUTES 3/16 C.R.
Merid. WILLAMETTE N.F. DESCHUTES State OREGON SEC. 196

SEE: D-01 T17S R11E

EV. KD.

D-25

Index

File No.

0155

CORNER RECORD (SEARCH) Contract or

(Ref. FSM 7151.4)

Survey No.

Cor.

No.

E-01

T 17 S. R. 10 E. R.D.

SISTERS

County DESCHUTES

NW Cor. of

Merid. Willamette

N.F. Deschutes

State Oregon

Section 7

CORNER DIAGRAM per Legend

DESCRIBE CORNER MONUMENT FOUND

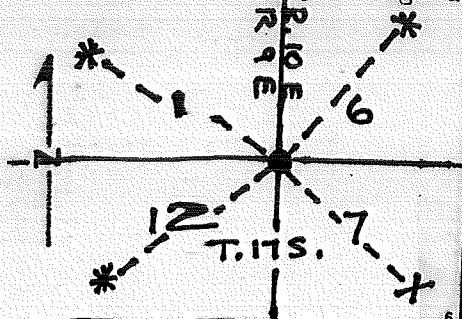

There are no remains of the original post

DESCRIBE BEARING TREES OR OTHER OFFICIAL ACCESSORIES FOUND

Found an 11" Lodgepole Pine with partially healed upper and lower blazes. I could see scribing inside but could not read it. This tree was faced for the SE B.T. and also had a Conklin beaver tail blazed on it.

Found a dead and down and decaying Lodgepole Pine in the SW location with a scribed R9ES12.

There was wood in the locations for the NE and NW trees, but they were decayed beyond recognition. I could not even discern a stump or root location for this wood.

DESCRIBE CORNER LOCATION RELATIVE TO NEAR-BY FEATURES, ALSO HOW TO REACH CORNER

PHOTO IDENTIFICATION DATA

Photo No.

Filed At

Object Ident.

Ident. By

Signature

CORNER LEGEND:

FS or Unverified
Contr. Other

○ ◇ Searched For/Not Found

⊗ ⊗ Evidence Found/Accept.

● ◆ Permanent Mon. Set/Pd.

Searched By:

W. Miller

Title

PLS

Division

CS

Headquarters

SO

Date

1985

CORNER RECORD (PERPETUATION)

MONUMENT. DESCRIBE NEW MONUMENT SET, OR WORK DONE TO PRESERVE EXISTING MONUMENT

Set a 2 1/2" X 30" Aluminum capped aluminum pipe, rising 6" in a stone mound, from a Dist.- Dist. intersect from the 2 remaining B.T.'s.

MONUMENT STAMPED

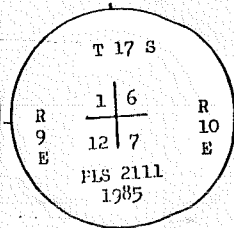

ACCESSORIES DESCRIBE NEW BT'S WITNESS OBJECTS ETC. ESTABLISHED, OR WORK DONE TO PRESERVE EXISTING EVIDENCE

- 1) A 1 1/2" Lodgepole Pine bears S47°E at 10.86 Ft. to a 60-Penny spike in the NE base; Orig. B.T., Partially healed.
- 2) A 7" White Fir Bears S46 1/2°W at 19.97 Ft. to a 60-Penny spike in the SE base, mkd. T17SR9ES12BT.
- 3) A 7" White Fir bears N42 1/4°W at 18.70 Ft. to a 60-Penny spike in the SW base, mkd. T17SR9ES1BT.
- 4) A 8" White Fir bears N28°E at 27.80 Ft. to a 60-Penny spike in the W base, mkd. T17SR10ES6BT.

Work Done By W. Miller Title PLS Date 6/85 State Registration No. or Agency 2111
 Prepared For Record Prepared? Yes No Filed At Des. Co. Surveyor's Office Date 6/21/85

History of Surveys, G.L.O., etc. — Set post for corner to Secs 6,7,1 & 12 from which
 — A pine 7 in diam bears N 42°E 14 lks dist
 — A pine 9 " " " N 49°W 16 " "
 — A pine 7 " " " S 57°W 9 " "
 — A pine 6 " " " S 46°E 16 " "

Index File No. T: S., R. E., W.M. Contract or Surv. No Cor E-01

OISS

17 10

USDA-FOREST SERVICE

Index File No. 0355

CORNER RECORD (SEARCH)

(Ref. FSM 7151.4)

Tract or Survey No. _____

Cor. No. E-03

T T17S R. R10E

R.D. Sisters

County Deschutes

5 1/4 S. 6

Merid. WMT

N.F. DNF

State OR

CORNER DIAGRAM

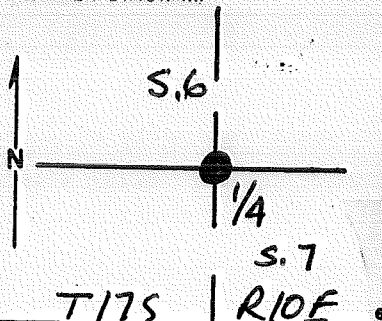

DESCRIBE CORNER MONUMENT FOUND

SFNF

DESCRIBE BEARING TREES OR OTHER OFFICIAL ACCESSORIES FOUND

FOUND PINE STUMP WITH SCRIBED FACE IN SECTION 7
S57°E 20 LINKS

PHOTO IDENTIFICATION DATA

Photo No. _____

Filed At. _____

Object Ident. _____

Ident. By _____

Signature

PLANE COORDINATE POSITION DATA

State _____ Zone _____

X _____

Y _____

Estab. By _____

Agency

Signature

Title

Division

Headquarters

Date

FS-7100-52 (3/68)

Don Greedel

PLS

6/8/02

CORNER RECORD (PERPETUATION)

MONUMENT: DESCRIBE NEW MONUMENT SET, OR WORK DONE TO PRESERVE EXISTING MONUMENT

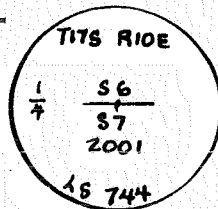

SET 2" IRON PIPE WITH 2 1/2" BRASS CAP AT RECORD POSITION FROM ORIGINAL B.T. STUMP
SCRIBED NEW BEARING TREES AS FOLLOWS:

- 12" WHITE FIR BEARS N51°00'W, 10³ FT. SCRIBED 1/4 S6 BT
- 7" " " " N77°44'E, 22⁶ FT. " X BT
- 9" " " " S62°25'E, 28³ FT. " X BT
- 7" " " " S33°10'W, 34¹ FT. " 1/4 S7 BT

MEASUREMENTS ARE TO CENTER OF TREE AT ROOT CROWN
A BRASS DISC STAMPED "LS 744" IS NAILED IN LOWER BLAZE

RESERVE EXISTING EVIDENCE

Work Done By Don Gresdel Title PLS Date 6/02 State Registration No. 744
or Agency

Certified Cor. Record Prepared Yes No Filed At: Dec Co. Date

REMARKS

G.L.O. 1879 BY THOMPSON, MELDRUM AND MOORE
ORIGINAL CORNER MONUMENTED WITH WOOD POST AND REFERENCED
WITH 2 BEARING TREES:
20" PINE N5°E 35 LINKS
28" " S57°E 20 LINKS

Index File No. 0355 T. R. M. Tract or Surv. No. Cor. E-03
GPO: 1986 O-439-095

Index File No. 0555

CORNER RECORD (SEARCH). Contract or Survey No. _____
(Ref. FSM 7151.4)

Cor. No. E-05

T 17 S. R. 10 E. R.D. BEND

County DESCHUTES

SE Cor. of

Merid. Willamette

N.F. Deschutes

State Oregon

Section 6

CORNER DIAGRAM per legend

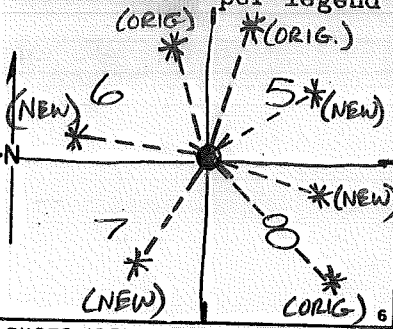

DESCRIBE CORNER MONUMENT FOUND

12/86 - Walt Miller (PLS 2111) SF/NF

DESCRIBE BEARING TREES OR OTHER OFFICIAL ACCESSORIES FOUND

S.E. BT 21" STUMP, 5' HIGH, SCBD "58"

N.E. BT 25" STUMP, 2' HIGH, BT BLAZE, SCRIBE NOT LEGIBLE

N.W. BT 12" DOWNED LOG, SCBD "R10"

12/86 - The SW BT IS UNDER ROAD FILL.

PHOTO IDENTIFICATION DATA

Photo No. _____
Filed At. _____
Object Ident. _____
Ident. By _____
Signature _____

DESCRIBE CORNER LOCATION RELATIVE TO NEAR-BY FEATURES, ALSO HOW TO REACH CORNER

~~SIGN~~ SIGN BOARD ON ROAD

CORNER LEGEND:

- FS or Contr. Unverified Other
- ◇ Searched For/Not Found
- ⊗ ⊗ Evidence Found/Accept.
- ◆ Permanent Mon. Set/Fd.

Searched By: SC

Title ST Division CS Headquarters

SO Date 11-7-83

CORNER RECORD (PERPETUATION)

MONUMENT STAMPED

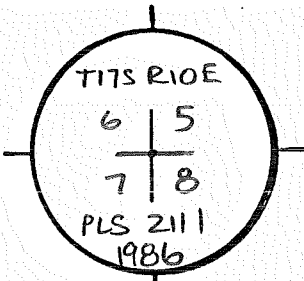

MONUMENT: DESCRIBE NEW MONUMENT SET, OR WORK DONE TO PRESERVE EXISTING MONUMENT

12/86 - Walt Miller:
 Set a 2 1/2" x 30" ACAP RISING 8" in stone mound
 USING DIST-DIST. INTERSECTS FROM THE 3 BT'S

ACCESSORIES: DESCRIBE NEW BT'S WITNESS OBJECTS ETC. ESTABLISHED, OR WORK DONE TO PRESERVE EXISTING EVIDENCE

12/86 - Walt Miller SET:
 A 10" P. pine brs N49°E @ 7 1/2', to a 60-d SPIKE IN SE base, MKD T17SR10ES5BT
 " 10" W. Fir " S78 1/2° E " 7 1/2' " " " " " SSW " " T17SR10ES8BT
 AN 11" P. pine " S29 1/2° W " 12 3/4' " " " " " ESE " " T17SR10ES7BT
 " " " " " N77° W " 8° " " " " " N " " T17SR10ES6BT.

Work Done By Walt Miller Title PLS Date 12/86 State Registration No. 2111
 or Agency
 Plat or Certified Cor. Record Prepared? Yes No Filed At: Des Co. Surveyor's Office Date 12/18/86

History of Surveys, G.L.O., etc.
24" PINE, N15°E, @ 34°
9" PINE, N21°W, @ 15 8
24" PINE, S32°W, @ 18 4
14" PINE, S61°E, @ 13 2

Index File No. 0755

CORNER RECORD (SEARCH) Contract or Survey No. _____
(Ref. FSM 7151.4)

Cor. No. E-07

T 17 S. R. 10 E. R.D. BEND

County DESCHUTES

Cor. of S/A

Merid. Willamette

N.F. Deschutes

State Oregon

Section 5

CORNER DIAGRAM per legend

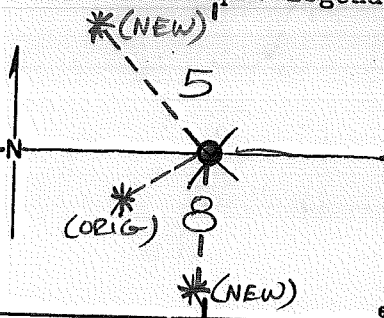

DESCRIBE CORNER MONUMENT FOUND

12/86 - Walt Miller (PLS# 2111) SF/NF

DESCRIBE BEARING TREES OR OTHER OFFICIAL ACCESSORIES FOUND

20" SNAG, S 58° W, @ 23' SCBD " 1/4 S BT "

PHOTO IDENTIFICATION DATA

Photo No. _____
Filed At. _____
Object Ident. _____
Ident. By _____
Signature

DESCRIBE CORNER LOCATION RELATIVE TO NEAR-BY FEATURES, ALSO HOW TO REACH CORNER

FALLS ON EDGE OF ROAD

CORNER LEGEND:

- FS or Contr. Unverified Other
- Searched For/Not Found
- Evidence Found/Accept.
- Permanent Mon. Set/Pd.

Searched By: S.C.

Title ST Division CS Headquarters SO Date 11-7-83

CORNER RECORD (PERPETUATION)

MONUMENT: DESCRIBE NEW MONUMENT SET, OR WORK DONE TO PRESERVE EXISTING MONUMENT

Set 2 1/2" X 30" ACAP RISING 12" IN a stone mound,
 using Record bearings and distance from the re-
 mains SW tree:

MONUMENT STAMPED

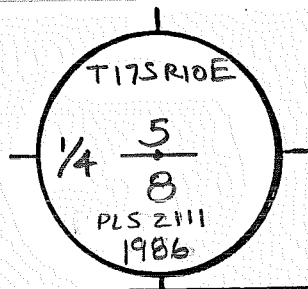

9

ACCESSORIES: DESCRIBE NEW BT'S WITNESS OBJECTS ETC. ESTABLISHED, OR WORK DONE TO PRESERVE EXISTING EVIDENCE

12/86 - (Walt Miller) SET:

A 8" P. pine brs S00 1/2° W @ 80 3', to a 60d spike in W base, MKD 1/4 S 8 BT.

A 14" " " " N43 1/2° W @ 71 35', " " " " SW " " 1/4 S 5 BT

10

Work Done By W. Miller Title PLS Date 12/86 State Registration No. 2111
 or Agency
 Plat or Certified Cor. Record Prepared? Yes No Filed At: Des Co. Surveyor's Office Date 12/18/86

History of Surveys, G.L.O., etc.

Set Post:

A pine 6" dia brs N27° E @ 50 lks dist,
 A, " 24" " " S58° W @ 36 " "

Index File No.

0755

T. 17 S., R. 10 E., W.M.

Contract or Surv. No.

Cor. E-07 13

12

Index File No. 1155

CORNER RECORD (SEARCH). Contract or Survey No. _____
(Ref. FSM 7151.4)

Cor. No. E-11

T 17 S. R. 10 E. R.D. BEND

County DESCHUTES

S/4 Cor. of

Merid. Willamette

N.F. Deschutes

State Oregon

Section 4

CORNER DIAGRAM per legend

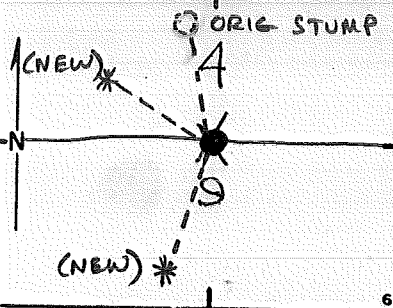

DESCRIBE CORNER MONUMENT FOUND

12/86 - Walt Miller (PLS 2111) SF/NF

DESCRIBE BEARING TREES OR OTHER OFFICIAL ACCESSORIES FOUND

2' STUMP N10°W @ 23 BOTTOM BLADE W/BT

6 FOUND PIECES OF SW TREE (BLADE W/AXE MARKS)
TRANSPORTER ?? (Beam me up, scotty....)

DESCRIBE CORNER LOCATION RELATIVE TO NEAR-BY FEATURES, ALSO HOW TO REACH CORNER

7 PAVED 2600' WEST OF SECTION CORNER

PHOTO IDENTIFICATION DATA

Photo No. _____
Filed At. _____
Object Ident. _____
Ident. By _____
Signature _____

CORNER LEGEND:

FS or Contr.	Unverified Other	
○	◇	Searched For/Not Found
⊗	⊗	Evidence Found/Accept.
●	◆	Permanent Mon. Set/Fd.

Searched By: S. CHAMBERLIN

Title S.T. Division CS Headquarters SO Date 6-14-84

CORNER RECORD (PERPETUATION)

MONUMENT: DESCRIBE NEW MONUMENT SET, OR WORK DONE TO PRESERVE EXISTING MONUMENT

SET A 2 1/2" X 30" ACAP RISING 5" IN A ROCK COLLAR USING RECORD BEARING AND DISTANCE FROM THE NW TREE (WM-12/86)

MONUMENT STAMPED

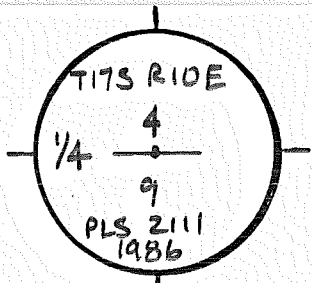

ACCESSORIES: DESCRIBE NEW BT'S WITNESS OBJECTS ETC. ESTABLISHED, OR WORK DONE TO PRESERVE EXISTING EVIDENCE

W. Miller (12/86):

A 9" P. pine bears N59°W @ 6.6 FT, TO A 60-d SPIKE IN SW BASE, MKD 1/4 S4 BT

A 10" P. PINE brs S 28°W @ 45.1 FT, TO A 60-d SPIKE IN SE BASE, MKD 1/4 S9 BT.

Work Done By W. Miller Title PLS Date 12/86 State Registration No. 2111 or Agency
Plat or Certified Cor. Record Prepared? Yes No Filed At: Des. Co. Surveyor's Office Date 12/18/86

History of Surveys, G.L.O., etc.
12" PINE N10°W @ 23¹⁰ POST
8" " S16°W @ 23⁷

Index
File No. 1355

CORNER RECORD (SEARCH)
(Ref. FSM 7151.4)

Tract or
Survey No. _____
Cor. No. E-13

T 17 S. R. 10 E. R.D. Bend County Deschutes SW cor.

Merid. WM N.F. DNF State OR Sec. 3

CORNER DIAGRAM

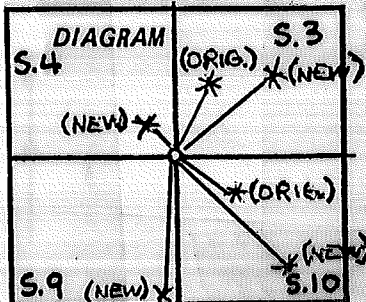

DESCRIBE CORNER MONUMENT FOUND

SF/NF

2

DESCRIBE BEARING TREES OR OTHER OFFICIAL ACCESSORIES FOUND

- 1) 16" stump scribed BT in SE location.
 - 2) 34" stump with a healed over blaze/scar 8" from the center of the stump, in NE location.
- The NW & SW trees fall in a road.

3

DESCRIBE CORNER LOCATION RELATIVE TO NEAR-BY FEATURES, ALSO HOW TO REACH CORNER

PHOTO IDENTIFICATION DATA

Photo No. _____
Filed At. _____
Object Ident. _____
Ident. By _____
Signature _____

7

PLANE COORDINATE POSITION DATA

State _____ Zone _____
X _____
Y _____
Estab. By _____
Agency _____

8

4

Signature
Walt Miller

Title
PLS

Division
CS

Headquarters
SO

Date
12/86

5

CORNER RECORD (PERPETUATION)

MONUMENT: DESCRIBE NEW MONUMENT SET, OR WORK DONE TO PRESERVE EXISTING MONUMENT

Using a dist.-dist. int ersect from the two remaining trees; I set a 2½" X 30" Aluminum Pipe Aluminum Cap rising 6", from which:

A 7" Ponderosa Pine bears N48½°E at 34.8 ft., to a 60-Penny spike in the NW base, marked T17SRLOES3BT.

A 5" Ponderosa Pine bears S36°E at 42.4 ft., to a 60-Penny spike in the NE base, marked X BT.

ACCE: A 9" Ponderosa Pine bears S04½°W at 51.1 ft., to a 60-Penny spike in the E base, marked T17SRLOES9BT.

A 6" Ponderosa Pine bears N31½°W at 3.2 ft., to a 60-Penny spike in the SW base, marked T17SRLOES10BT.

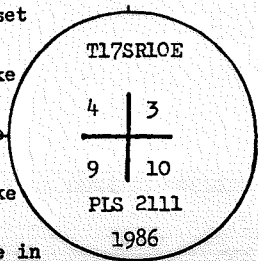

RESULTING DATA TO ORIGINAL TREES:

- 1) S47°E at 19.1 ft. to 16" stump.
- 2) N23½°E at 15.8 ft. to ¾" stump.

Work Done By Walt Miller Title PLS Date 12/18/06 State Registration No. 2111 or Agency _____

Certified Cor. Record Prepared? Yes No Filed At: Des Co. Date 12/18/06

Original Survey By Thompson, Meldrum & Moore Date 11/29/1879

ORIGINAL DESCRIPTION:

Set post for corner to Secs 3, 4, 9 & 10 from which:

- A pine 16 in diam bears N 25° E 24 lks dist
- A Pine 9 in diam bears N 67° W 28 lks dist
- A pine 10 " " " S 11° W 38 " "
- A pine 10 " " " S 48° E 29 " "

Index File No. 1355 T. 17 R. 10 M. _____ Tract or Surv. No. _____ Cor. E-13

Index
File No. 2555

CORNER RECORD (SEARCH)
(Ref. FSM 7151.4)

Tract or
Survey No. _____
Cor. No. E-25

T 17S R. 10E R.D. _____ County Deschute SECOR, SEC. 1
Merid. Will N.F. Deschute State Oregon NW COR, SEC. 7

CORNER DIAGRAM

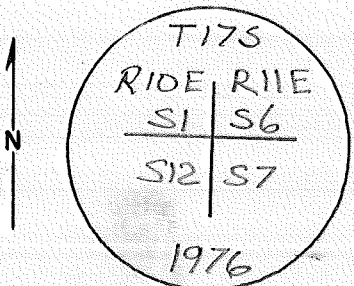

DESCRIBE CORNER MONUMENT FOUND

AT Orig Cor Secs 1, 6, 7 & 12 on West Bdy TP., mon By George W. Newman in 1871 with A Basalt Stone 13"x8"x9" (Rec. 13"x8"x6") Firmly set in small Mound Stone mkd with 1 notch on N Edge, Cor Pt. Has Been 2

DESCRIBE BEARING TREES OR OTHER OFFICIAL ACCESSORIES FOUND

Perpetuated with A 1" x 28" P.P. @ A 2" BC MKD.
A Pine 25" Dia, Brs S43°E, 61 Ks Dist, with 11leg. Scribe mks Visible in Partially Healed Double Blaze ⊕
24" P. PINE S74°E B/S (OR 16. BT) ?
23" P. PINE S32°E B/S (OR 16. BT) ? 3

PHOTO IDENTIFICATION DATA

Photo No. _____
Filed At. _____
Object Ident. _____
Ident. By _____

Signature

PLANE COORDINATE POSITION DATA

State _____ Zone _____
X _____
Y _____
Estab. By _____
Agency

DESCRIBE CORNER LOCATION RELATIVE TO NEAR-BY FEATURES, ALSO HOW TO REACH CORNER

860' W. of O. ANDREWS ROAD

Signature D.F.

Title J.A. Division

Headquarters

Date 10/79 7100-52-(3/68)

Dan Sankwich

Survey Tech

7/76

CORNER RECORD (PERPETUATION)

MONUMENT: DESCRIBE NEW MONUMENT SET, OR WORK DONE TO PRESERVE EXISTING MONUMENT

AT Cor PT Set a 2 1/2" x 28" I.P. 24" in GRND.
 Orig Stone Deposited A Long side IP; Other IP Placed inside BLM IP
 Raised Mound of Stone 2 1/2 ft Base to Top of IP.

9

ACCESSORIES : DESCRIBE NEW BT's WITNESS OBJECTS ETC. ESTABLISHED, OR WORK DONE TO PRESERVE EXISTING EVIDENCE

A Pine 14" Brs N 24 1/4° E, 57 1/2 Ks. MKd. T17SR11ES6 BT
 A Pine 10" Brs S 77 1/4° W, 19 1/2 Ks MKd. T17SR10ES12 BT
 A Pine 6" Brs N 5 1/4° W, 65 1/2 Ks MKd. T17SR10ES1 BT

BT Tags Posted

10

Work Done By Joe Garrison Title BLM Date 7/76 State Registration No. _____
 or Agency _____

Certified Cor. Record Prepared? Yes No Filed At: _____ Date _____

11

REMARKS

Index File No. 2555 T. 17 R. 10 M. Tract or Surv. No. _____ Cor. E-25¹²₁₃

Index

File No. 0557

CORNER RECORD (SEARCH)

(Ref. FSM 7151.4)

Tract or Survey No. _____

Cor. No. G-05

T 17 S. R. 10 E. R.D. SISTERS

County DESCHUTES

W/4 S.8

Merid. WM

N.F. DNF

State OR

CORNER DIAGRAM

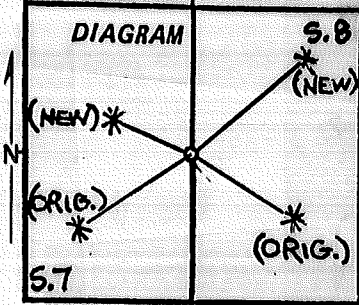

DESCRIBE CORNER MONUMENT FOUND

SF/NF

DESCRIBE BEARING TREES OR OTHER OFFICIAL ACCESSORIES FOUND

- 1.) 20" Hemlock stump with blade marked 1/4 in the SE location.
- 2.) 18" down Pine in the SW location marked 1/4SBT.

PHOTO IDENTIFICATION DATA

Photo No. _____

Filed At. _____

Object Ident. _____

Ident. By _____

Signature

PLANE COORDINATE POSITION DATA

State _____ Zone _____

X _____

Y _____

Estab. By _____

Agency

Signature

Walt Miller

Title

PLS

Division

CS

Headquarters

SO

Date

12/06

CORNER RECORD (PERPETUATION)

MONUMENT: DESCRIBE NEW MONUMENT SET, OR WORK DONE TO PRESERVE EXISTING MONUMENT

Set 2½" X 30" Aluminum Pipe Aluminum Cap rising 7" in a rock mound using a dist.-dist. intersect, from which:

A 9" White Fir bears N61½°W at 20.6 ft., to a 60-Penny spike in the NNE base, marked 1/4S7BT.

A 14" Lodgepole Pine bears N43°E at 61.2 ft., to a 60-Penny spike in the NW base, marked 1/4S8BT.

AC

RESULTING DATA TO ORIG. BT'S:

- 1) S55°E at 42.2 ft. Hemlock stump.
- 2) S23°W at 31.0 ft. to down pine log.

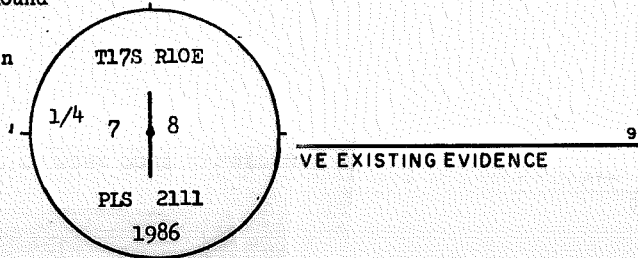

10

Work Done By Walt Miller Title PLS Date 12/86 State Registration No. 2111
or Agency

Certified Cor. Record Prepared? Yes No Filed At: Des: Co: Date 12/18/87

11

Original Survey By Thompson, Meldrum & Moore Date 11/24/1879

ORIGINAL DESCRIPTION:

Set post for 1/4 Sec corner from which

A Pine 18 in diam bears S 17° W 47 lks dist
A Hemlock 14 " " " S 60° E 64 " "

12

Index File No. 0557 T. 17S, R. 10E, M. WM

Tract or Surv. No.

Cor. G-OS

13

Index File No. 0957

CORNER RECORD (SEARCH) Contract or Survey No. (Ref. FSM 7151.4)

Cor. No. G-09

T 17 S. R. 10 E. R.D. BEND

County DESCHUTES

E/4 Cor. of

Merid. Willamette

N.F. Deschutes

State Oregon

Section 8

CORNER DIAGRAM per legend

DESCRIBE CORNER MONUMENT FOUND

S.F.N.F

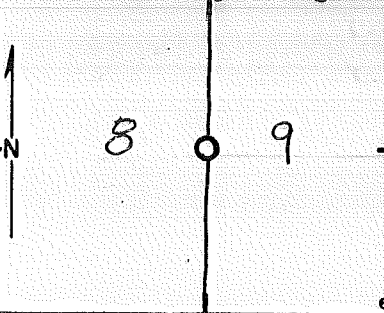

DESCRIBE BEARING TREES OR OTHER OFFICIAL ACCESSORIES FOUND

FALLS IN MIDDLE OF QUARRY SITE. NOT TOO MANY STUMPS IN AREA. CATTED OVER

PHOTO IDENTIFICATION DATA

Photo No. _____
Filed At. _____
Object Ident. _____
Ident. By _____
Signature

DESCRIBE CORNER LOCATION RELATIVE TO NEAR-BY FEATURES, ALSO HOW TO REACH CORNER

CORNER LEGEND:

- FS or Unverified
- Contr. Other
- Searched For/Not Found
- Evidence Found/Accept.
- Permanent Mon. Set/Fd.

Searched By: SC

Title ST Division CS Headquarters SO Date 11-7-83

CORNER RECORD (PERPETUATION)

MONUMENTS : DESCRIBE NEW MONUMENT SET, OR WORK DONE TO PRESERVE EXISTING MONUMENT

MONUMENT STAMPED

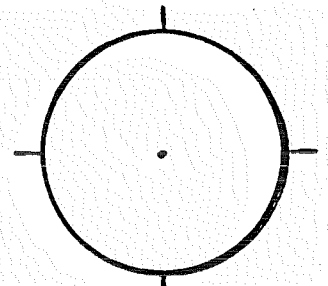

ACCESSORIES : DESCRIBE NEW BT'S WITNESS OBJECTS ETC. ESTABLISHED, OR WORK DONE TO PRESERVE EXISTING EVIDENCE

Work Done By _____ Title _____ Date _____ State Registration No. or Agency _____
Plat or Certified Cor. Record Prepared? Yes No Filed At: _____ Co. Surveyor's Office Date _____

History of Surveys, G.L.O., etc. 18" PINE, S 80° E, @ 92
16" PINE, N 72° W, @ 85

Index File No. 0957 T. 17S., R. 10 E., W.M. Contract or Surv. No. _____ Cor. 6-09

Index
File No. 2557

CORNER RECORD (SEARCH)
(Ref. FSM 7151.4)

Tract or
Survey No.

Cor.
No. G-25

T 17 S. R. 10 E.

R.D. SISTERS

County DESCHUTES

E/4 Cor. Sec. 12

Merid. WILLAMETTE

N.F. DESCHUTES

State OREGON

W/4 Cor. Sec. 7

SEE: G-01 T175 R11E

SF/WF

G-25

Index File No. 0559

CORNER RECORD (SEARCH) Contract or Survey No. _____
(Ref. FSM 7151.4)

Cor. No. J-05

T. 17 S. R. 10 E. R.D. BEND

County DESCHUTES

SE Cor. of

Merid. Willamette

N.F. Deschutes

State Oregon

Section 7

CORNER DIAGRAM per legend

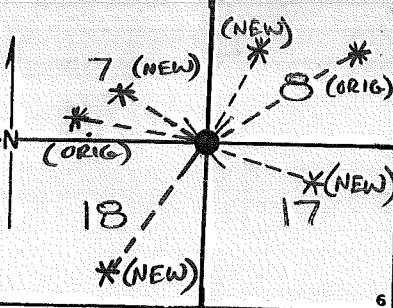

DESCRIBE CORNER MONUMENT FOUND

12/86 - Walt Miller (PLS 2111) - SE/NF

DESCRIBE BEARING TREES OR OTHER OFFICIAL ACCESSORIES FOUND

16" DOWN LOG, N 58° E, @ 40' SCBD "S" BT "
6" DOWN ROTTED LOG, N 60° W, @ 21' SCBD "T175R10ES7 BT "

PHOTO IDENTIFICATION DATA

Photo No. _____
Filed At. _____
Object Ident. _____
Ident. By _____
Signature _____

12/86 - Walt Miller FD BADLY DECAYED WOOD IN SW LOCATION,
- WOOD W/ FAINT SCRIBING IN SE LOCATION,

DESCRIBE CORNER LOCATION RELATIVE TO NEAR-BY FEATURES, ALSO HOW TO REACH CORNER

FOLLOW #1750 TO SIGN BOARD ON NORTH SIDE OF ROAD (230' NORTH)

CORNER LEGEND:

- | | | |
|----------------------------------|-------------------------------------|------------------------|
| FS or Contr. | Unverified Other | |
| <input type="radio"/> | <input type="checkbox"/> | Searched For/Not Found |
| <input checked="" type="radio"/> | <input checked="" type="checkbox"/> | Evidence Found/Accept. |
| <input checked="" type="radio"/> | <input checked="" type="checkbox"/> | Permanent Mon. Set/Fd. |

Searched By: S.C.

Title ST Division SO Headquarters SO Date 11-7-83

CORNER RECORD (PERPETUATION)

MONUMENTS: DESCRIBE NEW MONUMENT SET, OR WORK DONE TO PRESERVE EXISTING MONUMENT

SET 2 1/2" x 30" ACAP RISING 3" USING THE RECORD CALLS FOR THE NE AND NW TREES, (WM-12/86)

MONUMENT STAMPED

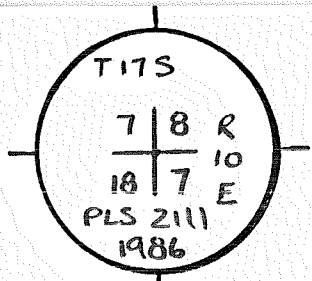

ACCESSORIES: DESCRIBE NEW BT'S WITNESS OBJECTS ETC. ESTABLISHED, OR WORK DONE TO PRESERVE EXISTING EVIDENCE

WM (12/86) SET:

A 6" L.P. Pine btr N20° E @ 13 1/2 FT, TO A 60-d SPIKE IN WNW base MKD T17SR10ES8BT

A 5" " " " S 73 1/2° E @ 8⁰⁵ " " " " " NNE " " X BT

A 6" " " " S 29° W @ 60[±] " " " " " W " " T17SR10ES10BT

A 6" " " " N 49 1/2° W @ 15¹ " " " " " SW " " T17SR10ES7BT

Work Done By Walt Miller Title PLS Date 12/86 State Registration No. 2111
or Agency

Plat or Certified Cor. Record Prepared? Yes No Filed At: DES Co. Surveyor's Office Date 12/18/86

History of Surveys, G.L.O., etc.
 16" PINE, N 58° E, @ 40⁹ POST
 6" PINE, N 60° W, @ 21⁰
 9" PINE, S 74° W, @ 22⁰
 7" PINE, S 33° E, @ 25⁷

Index File No. 0559 T. 17S., R. 10 E., W.M. Contract or Surv. No. Cor. J-05

Index
 File No. 0759 CORNER RECORD (SEARCH) Contract or Survey No. J-07
 T 17 S. R. 10 E. R.D. BEND County DESCHUTES N.F. Deschutes State Oregon Section 8
 Merid. Willamette Cor. of

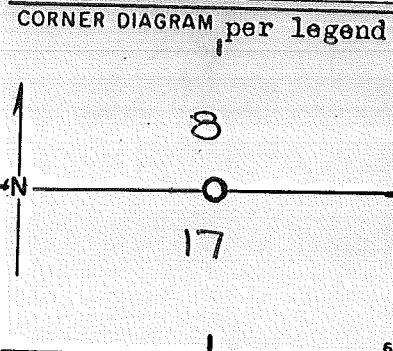

DESCRIBE CORNER MONUMENT FOUND
S.F.N.F.

DESCRIBE BEARING TREES OR OTHER OFFICIAL ACCESSORIES FOUND
9" PINE WITH AXE MARKS & BLAZE (LOCATION TREE?)

PHOTO IDENTIFICATION DATA
 Photo No. _____
 Filed At. _____
 Object Ident. _____
 Ident. By _____
Signature

DESCRIBE CORNER LOCATION RELATIVE TO NEAR-BY FEATURES, ALSO HOW TO REACH CORNER
STEEP & THICK PINE

CORNER LEGEND:
 FS or Unverified
 Contr. Other
 Searched For/Not Found
 Evidence Found/Accept.
 Permanent Mon. Set/Fd.

LOGGED A FEW YEARS AGO
50' NORTH OF SPUR RD. #490

Searched By S. CHAMBERLIN Title ST Division BS Headquarters SO Date 11-7-83

CORNER RECORD (PERPETUATION)

MONUMENTS DESCRIBE NEW MONUMENT SET, OR WORK DONE TO PRESERVE EXISTING MONUMENT

Blank lines for describing monument work.

MONUMENT STAMPED

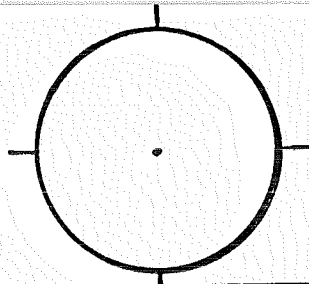

ACCESSORIES : DESCRIBE NEW BT'S WITNESS OBJECTS ETC. ESTABLISHED, OR WORK DONE TO PRESERVE EXISTING EVIDENCE

Blank lines for describing accessories and witness objects.

Work Done By _____ Title _____ Date _____ State Registration No. or Agency _____

Plat or Certified Cor. Record Prepared? Yes No Filed At: _____ Co. Surveyor's Office Date _____

History of Surveys, G.L.O., etc.

8" PINE, S68°E, @132
8" PINE, N72°W, @99

Post

Index File No. 0759

T. 17 S., R. 10 E., W.M.

Contract or Surv. No.

Cor. J-07

Index File No. 0959

CORNER RECORD (SEARCH) Contract or Survey No. _____
(Ref. FSM 7151.4)

Cor. No. J-09

T 17 S. R. 10 E. R.D. BEND

County DESCHUTES

SE Cor. of

Merid. Willamette

N.F. Deschutes

State Oregon

Section 8

CORNER DIAGRAM per legend

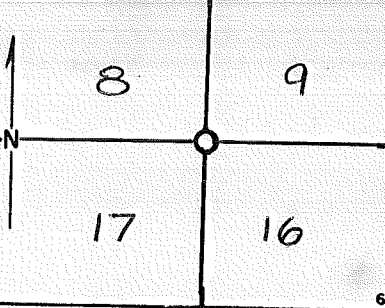

DESCRIBE CORNER MONUMENT FOUND S.F.N.F.

DESCRIBE BEARING TREES OR OTHER OFFICIAL ACCESSORIES FOUND

KNITTING NEEDLE
LOCATION TAG

ROTTED TREES IN ALL LOCATIONS

NO MARKS FOUND

LOTS OF BLOW DOWN

DESCRIBE CORNER LOCATION RELATIVE TO NEAR-BY FEATURES, ALSO HOW TO REACH CORNER

40' NORTH OF SPUR ROAD

PHOTO IDENTIFICATION DATA

Photo No. _____
Filed At. _____
Object Ident. _____
Ident. By _____
Signature

CORNER LEGEND:

- FS or Unverified
- Contr. Other
- Searched For/Not Found
- Evidence Found/Accept.
- Permanent Mon. Set/Fd.

Searched By: S. CHAMBERLIN Title ST Division CS Headquarters SO Date 11-7-83

CORNER RECORD (PERPETUATION)

MONUMENTS: DESCRIBE NEW MONUMENT SET, OR WORK DONE TO PRESERVE EXISTING MONUMENT

MONUMENT STAMPED

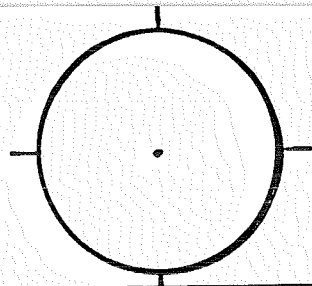

ACCESSORIES: DESCRIBE NEW BT'S WITNESS OBJECTS ETC. ESTABLISHED, OR WORK DONE TO PRESERVE EXISTING EVIDENCE

Work Done By _____ Title _____ Date _____ State Registration No. or Agency _____
Plat or Certified Cor. Record Prepared? Yes No Filed At: _____ Co. Surveyor's Office Date _____

History of Surveys, G.L.O., etc.
10" PINE, N35°E, @ 17²
16" PINE, N55°W, @ 13²
14" PINE, S18°W, @ 8⁵
6" PINE, S72°E, @ 23⁷

Index File No. 0859 T. 17 S., R. 10 E., W.M. Contract or Surv. No. Cor. J-0913

Index File No. 1159

CORNER RECORD (SEARCH) Contract or Survey No. (Ref. FSM 7151.4)

Cor. No. J-11

T 17 S. R. 10 E. R.D. BEND

County DESCHUTES

Section 9 Cor. of

Merid. Willamette N.F. Deschutes

State Oregon

CORNER DIAGRAM per legend

DESCRIBE CORNER MONUMENT FOUND

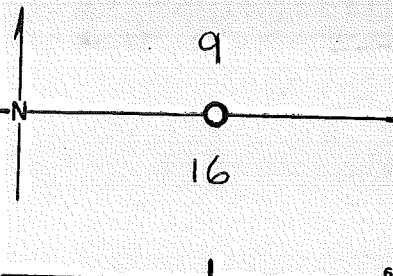

S. F. N. F.

DESCRIBE BEARING TREES OR OTHER OFFICIAL ACCESSORIES FOUND

BIG STUMPS CUT & BURNED BAD

PHOTO IDENTIFICATION DATA

Photo No. _____
Filed At. _____
Object Ident. _____
Ident. By _____
Signature

DESCRIBE CORNER LOCATION RELATIVE TO NEAR-BY FEATURES, ALSO HOW TO REACH CORNER

CORNER LEGEND:

FS or Contr.	Unverified Other	
<input type="radio"/>	<input type="checkbox"/>	Searched For/Not Found
<input checked="" type="radio"/>	<input checked="" type="checkbox"/>	Evidence Found/Accept.
<input type="radio"/>	<input checked="" type="checkbox"/>	Permanent Mon. Set/Fd.

Searched By: S.C.

Title ST Division CS Headquarters SO Date 11-7-83

CORNER RECORD (PERPETUATION)

MONUMENTS DESCRIBE NEW MONUMENT SET, OR WORK DONE TO PRESERVE EXISTING MONUMENT

MONUMENT STAMPED

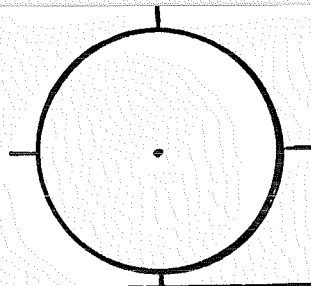

9

ACCESSORIES ; DESCRIBE NEW BT'S WITNESS OBJECTS ETC. ESTABLISHED, OR WORK DONE TO PRESERVE EXISTING EVIDENCE

10

Work Done By _____ Title _____ Date _____ State Registration No. or Agency _____

Plat or Certified Cor. Record Prepared? Yes No Filed At: _____ Co. Surveyor's Office Date _____

11

History of Surveys, G.L.O., etc.
24" PINE, N5°E, @ 35°
16" PINE, S65°E, @ 46°

Index File No.

1159

T. 17 S., R. 10 E., W.M.

Contract or Surv. No.

Cor. J-11

12

13

Index
File No. 1759

CORNER RECORD (SEARCH)

(Ref. FSM 7151.4)

Tract or Survey No. _____
Cor. No. J-17

T 17 S. R. 10 E, R.D. Bend County Deschutes
Merid. UM N.F. DNP State OR NW cor Sec. 14

CORNER DIAGRAM

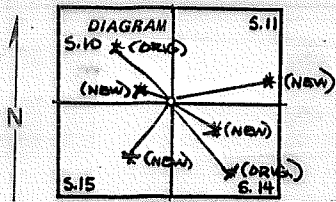

DESCRIBE CORNER MONUMENT FOUND

Description of corner evidence found:

Found original post out of the ground with visible scribes on three sides.

- 1) 31" Ponderosa Pine stump, which I removed a plug to find a very small portion of a scribed T (↖), in the SE location.
- 2) A 17" dead and down log and attached root wad marked R16E S10BT, in the NW location.

There was a stump in the NE location, but it was low stumped.
There was very decayed wood in the SW location, but nothing could be found.

DES:

6

PHOTO IDENTIFICATION DATA

Photo No. _____
Filed At. _____
Object Ident. _____
Ident. By _____
Signature

7

DESCRIBE CORNER LOCATION RELATIVE TO NEAR-BY FEATURES, ALSO HOW TO REACH CORNER

3

PLANE COORDINATE POSITION DATA

State _____ Zone _____
X _____
Y _____
Estab. By _____
Agency

8

Signature
Walt Miller

Title
PLS

Division
CS

Headquarters
SO

6/87

Date

FS-7100-52 (3/68)

4

CORNER RECORD (PERPETUATION)

MONUMENT: DESCRIBE NEW MONUMENT SET, OR WORK DONE TO PRESERVE EXISTING MONUMENT

Description of monument and accessories established to perpetuate the original location of this corner:

MONUMENT STAMPED:

Using record bearings and distances from the two solid BT's, I set a 2 1/2" X 30" Brass Capped Steel Pipe rising 1" in a stone mound, from which:
 A 18" Ponderosa Pine bears N72 1/4° E at 63.6 ft., to a 60-Penny spike in the NW base, marked T17SR10ES11BT.

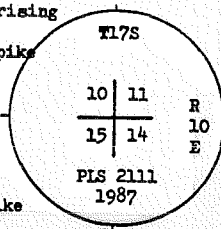

ACCES A 10" Ponderosa Pine bears S50 1/2° E at 19.05 ft., to a 60-Penny spike in the NE base, marked T17SR10ES14BT.
 A 9" Ponderosa Pine bears S26 1/4° W at 38.1 ft., to a 60-Penny spike in the SE base, marked T17SR10ES15BT.
 A 16" Ponderosa Pine bears N58 1/2° W at 9.4 ft., to a 60-Penny spike in the NE base, marked T17SR10ES10BT.

PRESERVE EXISTING EVIDENCE

RESULTS to remaining BT's:

- 1) S33° E at 55.3 ft.
- 2) N30° W at 32.4 ft.

Work Done By Walt Miller Title PLS Date 6/8/87 State Registration No. 2111
 or Agency _____
 Certified Cor. Record Prepared? Yes No Filed At: Deschutes Co. Date 6/11/87

Original Survey By Thompson, Meldrum & Moore Date 11/24/1879
 REMARKS

ORIGINAL DESCRIPTION:

Set post for corner to Secs 10.11. 14 & 15 from which:
 A pine 16 in diam bears N 33° E 53 lks dist
 A pine 18 " " " N 31° W 47 " "
 A pine 10 " " " S 30° W 129 " "
 A pine 16 " " " S 36° E 83 " "

In ~~dex~~
File No. 2559

T 17S R. 10 E

Merid. Will

CORNER RECORD (SEARCH)

(Ref. FSM 7151.4)

R.D. Sisters

County Deschutes

N.F. Deschutes

State Oregon

Tract or Survey No. _____

Cor. No. J-25

SE Cor, Sec. 12

NW Cor, Sec. 18

CORNER DIAGRAM

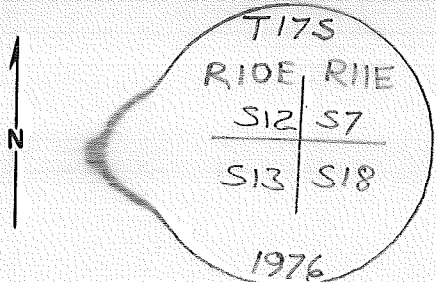

DESCRIBE CORNER MONUMENT FOUND

AT ORIG Cor Sacs 7, 12, 13, & 18 on N. Boundary T.P. mon By George W. Newman in 1871 with A Basalt Stone 16'x11'x8" (Rec 13'x9'x8") Firmly set in small mound of Stone, mkd with 2 Notches on N. Face.

DESCRIBE BEARING TREES OR OTHER OFFICIAL ACCESSORIES FOUND

A Down a Rotted Pine snag, 12" Diam, BRS N32°E (Rec N28°E), 94 lks Dist, with scribe mk "T" visible on Face opened By me.

DESCRIBE CORNER LOCATION RELATIVE TO NEAR-BY FEATURES, ALSO HOW TO REACH CORNER

Cor Falls at SW Cor of Rocky outcrop on Top of Rounded Hill.

1445' N. of Loc. TAG
630' N. of Loc. TAG on Spur

PHOTO IDENTIFICATION DATA

Photo No. _____

Filed At. _____

Object Ident. _____

Ident. By _____

Signature

PLANE COORDINATE POSITION DATA

State _____ Zone _____

X _____

Y _____

Estab. By _____

Agency

Signature

Title

Division

Headquarters

Date

Dan Sankwich

Survey Tech

7/76

Index
File No. 2559

CORNER RECORD (SEARCH)
(Ref. FSM 7151.4)

Tract or
Survey No. _____ Cor. No. J-25

T 17S R. 10 E R.D. Sisters County Wasco SE Cor. Sec. 12
Merid. Will N.F. Wasco State Oregon NW Cor. Sec. 18

CORNER DIAGRAM

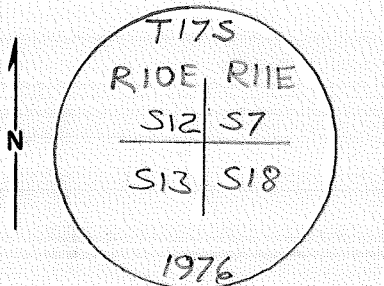

DESCRIBE CORNER MONUMENT FOUND

AT ORIG Cor Secs 7, 12, 13, & 18 on N. Boundary T.P.,
mon By George W. Newman in 1871 with A Basalt Stone
16"x11"x8" (Rec 13"x9"x8") Firmly set in small mound of
Stone, mkd with 2 Notches on N. Face.

2

DESCRIBE BEARING TREES OR OTHER OFFICIAL ACCESSORIES FOUND

A Down & Rotted Pine snag, 12" Diam, BRS N32°E
(Rec N28°E), 94 Iks Dist, with scribe mk "T" visible
on Face opened By me.

3

PHOTO IDENTIFICATION DATA

Photo No. _____
Filed At. _____
Object Ident. _____
Ident. By _____
Signature

DESCRIBE CORNER LOCATION RELATIVE TO NEAR-BY FEATURES, ALSO HOW TO REACH CORNER

Cor Falls at SW Cor of Rocky outcrop on
Top of Rounded Hill.

4

PLANE COORDINATE POSITION DATA

State _____ Zone _____
X _____
Y _____
Estab. By _____
Agency

1445' N. of Loc. TAG
630' N. of Loc. TAG on Spur

Signature Dan Sankwich Title Survey Tech Division _____ Headquarters _____ Date 7/76 7100-52-(3/68)

5

CORNER RECORD (PERPETUATION)

MONUMENT: DESCRIBE NEW MONUMENT SET, OR WORK DONE TO PRESERVE EXISTING MONUMENT

AT Cor PT. Set A $2\frac{1}{2}'' \times 28''$ IP 20" in Grnd, with BC Mk'd.
 Orig Stone Deposited Along side IP
 With A Raised Mound of Stone $2\frac{1}{2}$ FT Base To Top of IP.

9

ACCESSORIES: DESCRIBE NEW BT's WITNESS OBJECTS ETC. ESTABLISHED, OR WORK DONE TO PRESERVE EXISTING EVIDENCE

A Pine 18" Brs N 69° E, 20 IKs, Mk'd. T17S R11E S7 BT
 A Pine 8" Brs S 5° E, 49 $\frac{1}{2}$ IKs, Mk'd. T17S R11E S18 BT
 A Pine 6" Brs S $42\frac{1}{2}^{\circ}$ W, 65 IKs Mk'd. T17S R10E S13 BT
 A Pine 8" Brs. N $59\frac{3}{4}^{\circ}$ W 22 IKs Mk'd T17S R10E S12 BT

BT. Tags Posted

10

Work Done By Joe Garrison Title BLM Date 7/76 State Registration No. _____
 or Agency _____

Certified Cor. Record Prepared? Yes No Filed At: _____ Date _____

11

REMARKS

Index File No. 2559 T. 17 R. 10 M. _____ Tract or Surv. No. _____ Cor. J-25

12

13

Index File No. 0961 CORNER RECORD (SEARCH) Contract or Survey No. L-09
 (Ref. FSM 7151.4)
 T 17 S. R. 10 E. R.D. BEND County DESCHUTES E 1/4 Cor. of
 Merid. Willamette N.F. Deschutes State Oregon Section 17

CORNER DIAGRAM per legend

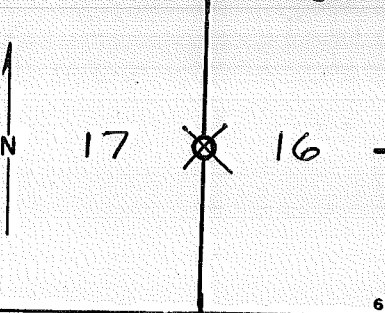

DESCRIBE CORNER MONUMENT FOUND

DESCRIBE BEARING TREES OR OTHER OFFICIAL ACCESSORIES FOUND

15" L. PINE, WEST @ 28' (BURNED) "S"

9" L. PINE, N 55° E, 6', AXE MARKS HEALED OVER

PHOTO IDENTIFICATION DATA

Photo No. _____
 Filed At. _____
 Object Ident. _____
 Ident. By _____
 Signature _____

DESCRIBE CORNER LOCATION RELATIVE TO NEAR-BY FEATURES, ALSO HOW TO REACH CORNER

PUT SIGN BOARD ON RD # 400, 150' EAST OF CORNER

- CORNER LEGEND:
- | | | |
|--------------|------------------|------------------------|
| FS or Contr. | Unverified Other | |
| ○ | ◇ | Searched For/Not Found |
| ⊗ | ⊗ | Evidence Found/Accept. |
| ● | ◆ | Permanent Mon. Set/Fd. |

Searched By: S. CHAMBERLIN Title ST Division CS Headquarters SO Date 11-7-83

CORNER RECORD (PERPETUATION)

MONUMENT: DESCRIBE NEW MONUMENT SET, OR WORK DONE TO PRESERVE EXISTING MONUMENT

MONUMENT STAMPED

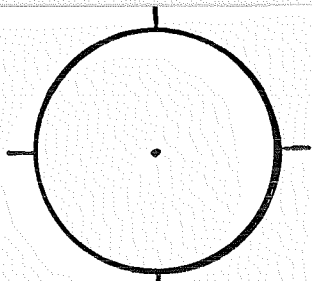

ACCESSORIES : DESCRIBE NEW BT'S WITNESS OBJECTS ETC. ESTABLISHED, OR WORK DONE TO PRESERVE EXISTING EVIDENCE

Work Done By _____ Title _____ Date _____ State Registration No. or Agency _____
Plat or Certified Cor. Record Prepared? Yes No Filed At: _____ Co. Surveyor's Office Date _____

History of Surveys, G.L.O., etc. 6" PINE, N55°E, @ 6" POST
10" PINE, WEST @ 28"

Index File No. 0961 T. 17 S., R. 10 E., W.M. Contract or Surv. No. Cor. L-09

Index
File No. 2561

CORNER RECORD (SEARCH)

(Ref. FSM 7151.4)

Tract or
Survey No.

Cor.
No. L-25

T 17 S. R. 10 E.

R.D. SISTERS

County DESCHUTES

E/4 Cor. Sec. 13

Merid. WILLAMETTE

N.F. DESCHUTES

State OREGON

W/4 Cor. Sec. 18

SEE: L-01 T17S R11E

SE/NE

L-25

Index
File No. 0563

CORNER RECORD (SEARCH)

(Ref. FSM 7151.4)

Tract or Survey No. _____
Cor. No. N-05

T 17 S. R. 10 E. R.D. Bend County Deschutes SW Cor

Merid. W.M. N.F. DNF State OR S. 17

CORNER DIAGRAM

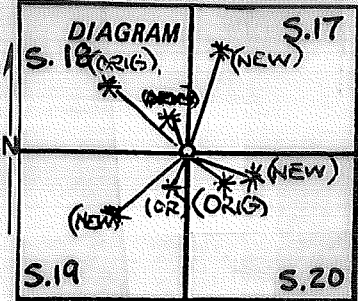

DESCRIBE CORNER MONUMENT FOUND

SF/NF

DESCRIBE BEARING TREES OR OTHER OFFICIAL ACCESSORIES FOUND

16" Hemlock in SW location; healed over.
10" Pine snag in SE location; scribed RLOES20BT.
Decayed log in the NW location, but no scribing identifiable.
There is wood in the NE location but nothing positive.

PHOTO IDENTIFICATION DATA

Photo No. _____
Filed At. _____
Object Ident. _____
Ident. By _____
Signature _____

DESCRIBE CORNER LOCATION RELATIVE TO NEAR-BY FEATURES, ALSO HOW TO REACH CORNER

PLANE COORDINATE POSITION DATA

State _____ Zone _____
X _____
Y _____
Estab. By _____
Agency _____

Signature
W. Miller

Title
PLS

Division
CS

Headquarters
SO

Date
12/86

7100-52-(3/68)

CORNER RECORD (PERPETUATION)

MONUMENT: DESCRIBE NEW MONUMENT SET, OR WORK DONE TO PRESERVE EXISTING MONUMENT

MONUMENT STAMPED:

Set a 2½" X 30" Aluminum Pipe Aluminum Cap rising 15" in a stone mound using record calls for the 2 remaining B.T.'s. from which:

A 13" Hemlock bears N20°E at 87.5 ft., to a 60-Penny spike in the WNW base, marked T17SR10ES17BT.

AC An 18" Hemlock bears S68°E at 45.9 FT., to a 60-Penny spike in the SW base, marked T17SR10ES20BT.

A 9" Hemlock bears S43°W at 63.1 FT., to a 60-Penny spike in the NW base, marked T17SR10ES19BT.

A 13" Hemlock bears N22°W at 10.0 FT., to a 60-Penny spike in the NE base, marked T17SR10ES18BT.

RESULTING DATA: 16" Hemlock bears S31°W at 3.5' :
 10" Pine Snag bears S65°E at 10.7' :
 Butt of decayed log bears N41°W at 19.4' :

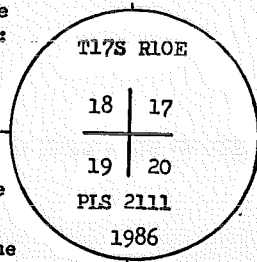

STING EVIDENCE

9

REGISTERED

10

Work Done By Walt Miller Title PLS Date 12/86 State Registration No. 211
 or Agency

Certified Cor. Record Prepared? (Yes) No Filed At: Des Co. Date 12/10/86 11

ORIGINAL DESCRIPTION:

Set post for corner to Secs 17,18,19 & 20 from which

- a Pine 9 in diam bears N 40° E 32 lks dist
- a " 12 " " " N 45° W 28 " "
- a Hemlock 12 in diam bears S 25° W 5 lks dist
- a Pine 12 in diam bears S 71° E 15 lks dist

12

Index File No. 0563 T. 17 R. 10 M. Tract or Surv. No. Cor. N-05 13

USDA-FOREST SERVICE

Index File No. 0763

CORNER RECORD (SEARCH)

(Ref. FSM 7151.4)

Tract or Survey No. _____ Cor. No. D-07

T 17 S R. 10 E

R.D. Bend County Deschutes

S 1/4 S.17

Merid. _____

N.F. _____ State _____

CORNER DIAGRAM

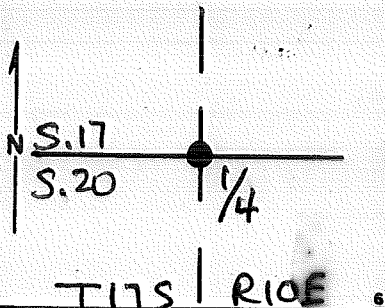

DESCRIBE CORNER MONUMENT FOUND

SFNF

DESCRIBE BEARING TREES OR OTHER OFFICIAL ACCESSORIES FOUND

FOUND PINE BEARING TREE WITH SCRIBED FACE, DOWN.

PHOTO IDENTIFICATION DATA

Photo No. _____

Filed At. _____

Object Ident. _____

Ident. By _____

Signature

PLANE COORDINATE POSITION DATA

State _____ Zone _____

X _____

Y _____

Estab. By _____

Agency

DESCRIBE CORNER LOCATION RELATIVE TO NEAR-BY FEATURES, ALSO HOW TO REACH CORNER

Signature

Don Greadel

Title

PLS

Division

Headquarters

Date

6/08/02

FS-7100-52 (3/68)

CORNER RECORD (PERPETUATION)

MONUMENT: DESCRIBE NEW MONUMENT SET, OR WORK DONE TO PRESERVE EXISTING MONUMENT

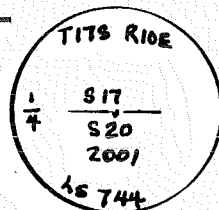

SET 2" IRON PIPE WITH 2 1/2" BRASS CAP AT RECORD POSITION FROM FOUND PINE B.T.
SCRIBED NEW BEARING TREES AS FOLLOWS:

- 12" FIR N66°34'W, 105 FT. SCRIBED 1/4 S17 BT
- 9" LODGEPOLE PINE N07°58'W, 125 FT. SCRIBED 1/4 S17 BT
- 7" FIR N59°30'E, 67 FT. SCRIBED X BT
- 6" " S72°16'E, 42 FT. " 1/4 S20 BT

E TO PRESERVE EXISTING EVIDENCE

MEASUREMENTS ARE TO CENTER OF TREE AT ROOT CROWN
A BRASS DISC STAMPED "LS 744" IS NAILED TO LOWER PLAZE

Work Done By Don Greedel Title PLS Date 6/8/02 State Registration No. 744
or Agency

Certified Cor. Record Prepared Yes No Filed At: Dec. Co. Date

REMARKS

G.L.O. BY THOMPSON, MELDRUM AND MOORE IN 1879
SET WOODEN POST FOR 1/4 CORNER
SCRIBED BEARING TREES:
20" HEMLOCK N20°W, 40 LINKS
12" PINE S22°E, 50 LINKS

Index File No. T. R. M. Tract or Surv. No. Cor.

0763

N-07

Index _____ Contract or
 File No. 0963 (Ref. FSM 7151.4) Survey No. _____ Cor. No. N-09
 T 17 S. R. 10 E. R.D. ~~PRESENT~~ BEND County DESCHUTES SE Cor. of
 Merid. Willamette N.F. Deschutes State Oregon Section 17

CORNER DIAGRAM per legend

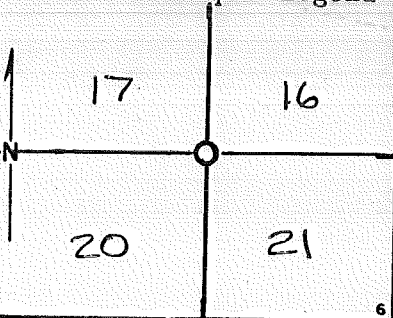

DESCRIBE CORNER MONUMENT FOUND

S.F.N.F.

DESCRIBE BEARING TREES OR OTHER OFFICIAL ACCESSORIES FOUND

OLD LOGS BURNED REAL BAD!

PHOTO IDENTIFICATION DATA

Photo No. _____
 Filed At. _____
 Object Ident. _____
 Ident. By _____
 Signature _____

DESCRIBE CORNER LOCATION RELATIVE TO NEAR-BY FEATURES, ALSO HOW TO REACH CORNER

300' EAST OF ROAD #1750

CORNER LEGEND:

- FS or Unverified
- Contr. Other
- Searched For/Not Found
- Evidence Found/Accept.
- Permanent Mon. Set/Fd.

(S.F.N.F. W. MILLER 6-12, 13-83)

Searched By: S. CHAMBERLIN Title ST Division CS Headquarters SO Date 11-7-83

CORNER RECORD (PERPETUATION)

MONUMENTS : DESCRIBE NEW MONUMENT SET, OR WORK DONE TO PRESERVE EXISTING MONUMENT

MONUMENT STAMPED

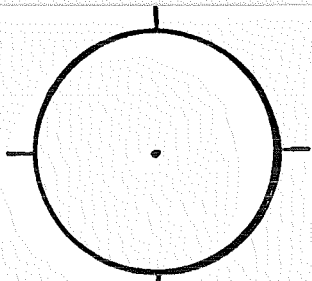

9

ACCESSORIES : DESCRIBE NEW BT'S WITNESS OBJECTS ETC. ESTABLISHED, OR WORK DONE TO PRESERVE EXISTING EVIDENCE

10

Work Done By _____ Title _____ Date _____ State Registration No. _____
 or Agency _____
 Plat or Certified Cor. Record Prepared? Yes No Filed At: _____ Co. Surveyor's Office Date _____

11

History of Surveys, G.L.O., etc.
 7" L.P. PINE, N33°E, @ 6⁶ Post
 6" L.P. PINE, N30°W, @ 5⁰
 6" L.P. PINE, S27°W, @ 13⁹
 7" L.P. PINE, S27°E, @ 15⁰

12

Index File No. 0963 T. S., R. E., W.M. Contract or Surv. No. _____ Cor. _____

13

Index File No. 1163

CORNER RECORD (SEARCH) Contract or Survey No. _____
(Ref. FSM 7151.4)

Cor. No. N-11

T 17 S. R. 10 E. R.D. BEND

County DESCHUTES

3/4 Cor. of

Merid. Willamette

N.F. Deschutes

State Oregon

Section 16

CORNER DIAGRAM per legend

DESCRIBE CORNER MONUMENT FOUND

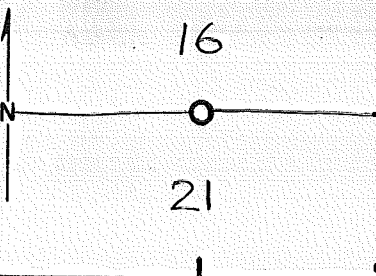

S.F.N.F.

DESCRIBE BEARING TREES OR OTHER OFFICIAL ACCESSORIES FOUND

CORNER TAG FOUND TREE IN N.W. LOCATION

6 ROTTED REAL BAD

PHOTO IDENTIFICATION DATA

Photo No. _____
Filed At. _____
Object Ident. _____
Ident. By _____
Signature

DESCRIBE CORNER LOCATION RELATIVE TO NEAR-BY FEATURES, ALSO HOW TO REACH CORNER

7 SIGN BOARD EAST SIDE OF ROAD

CORNER LEGEND:

FS or Unverified
Contr. Other

Searched For/Not Found

Evidence Found/Accept.

Permanent Mon. Set/Fd.

Searched By: SCHAMBERLIN

Title S.T.

Division CS

Headquarters SO

Date 6-18-84

CORNER RECORD (PERPETUATION)

MONUMENT: DESCRIBE NEW MONUMENT SET, OR WORK DONE TO PRESERVE EXISTING MONUMENT

MONUMENT STAMPED

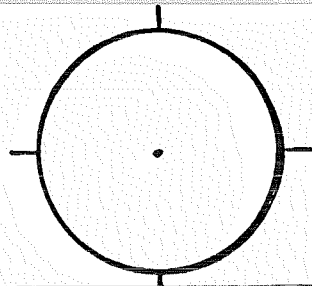

ACCESSORIES : DESCRIBE NEW BT'S WITNESS OBJECTS ETC. ESTABLISHED, OR WORK DONE TO PRESERVE EXISTING EVIDENCE

Work Done By _____ Title _____ Date _____ State Registration No. or Agency _____
Plat or Certified Cor. Record Prepared? Yes No Filed At: _____ Co. Surveyor's Office Date _____

History of Surveys, G.L.O., etc.
20" PINE N 5° W @ 26°
20" " S 50° W @ 25°

Index File No. 1163 T. 17 S., R. 10 E., W. M. Contract or Surv. No. Cor. N-11

Index File No. 1563

CORNER RECORD (SEARCH) Contract or Survey No. _____
(Ref. FSM 7151.4)

Cor. No. N-15

T 17 S. R. 10 E. R.D. BEND County DESCHUTES S/4 Cor. of
Merid. Willamette N.F. Deschutes State Oregon Section 15

CORNER DIAGRAM per legend

DESCRIBE CORNER MONUMENT FOUND

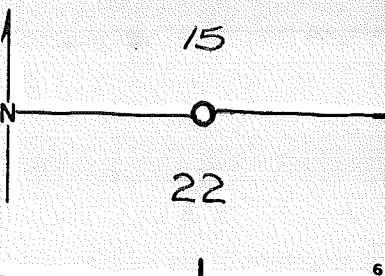

S.F. N.E.
(CORNER TAGS)

DESCRIBE BEARING TREES OR OTHER OFFICIAL ACCESSORIES FOUND

FOUND TWO PIECES OF WOOD W/ SCRIBING
HEAVY CATTED AREA! CANT TELL WHERE WOOD CAME FROM!

PHOTO IDENTIFICATION DATA

Photo No. _____
Filed At. _____
Object Ident. _____
Ident. By _____
Signature

DESCRIBE CORNER LOCATION RELATIVE TO NEAR-BY FEATURES, ALSO HOW TO REACH CORNER

1300' WEST OF SIGN BOARD

CORNER LEGEND:
FS or Unverified
Contr. Other
 Searched For/Not Found
 Evidence Found/Accept.
 Permanent Mon. Set/Fd.

Searched By: SCHAMBERLIN

Title S.T. Division CS Headquarters SO Date 6-14-84

CORNER RECORD (PERPETUATION)

MONUMENT STAMPED

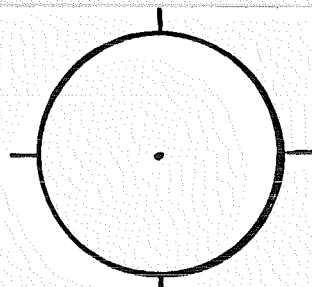

MONUMENT: DESCRIBE NEW MONUMENT SET, OR WORK DONE TO PRESERVE EXISTING MONUMENT

Three horizontal lines for describing the monument.

ACCESSORIES: DESCRIBE NEW BT'S WITNESS OBJECTS ETC. ESTABLISHED, OR WORK DONE TO PRESERVE EXISTING EVIDENCE

Five horizontal lines for describing accessories.

Work Done By _____ Title _____ Date _____ State Registration No. or Agency _____
Plat or Certified Cor. Record Prepared? Yes No Filed At: _____ Co. Surveyor's Office Date _____

History of Surveys, G.L.O., etc.

12" PINE N 11° E @ 17³
12" " S 70° W @ 13³

Index File No. 1563 T. 17 S., R. 10 E., W.M. Contract or Surv. No. Cor. N-15

Index
File No. 1763

CORNER RECORD (SEARCH)
(Ref. FSM 7151.4)

Tract or
Survey No. _____
Cor. No. N-17

T 17 S. R. 10 E. R.D. Bend County Deschutes

Merid. _____ N.F. _____ State _____ NW Cor Sec. 23

CORNER DIAGRAM

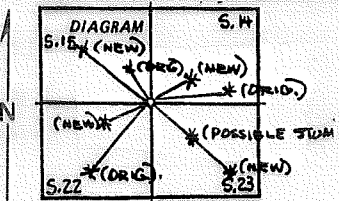

DESCRIBE CORNER MONUMENT FOUND

SF/NP

DESCRIBE BEARING TREES OR OTHER OFFICIAL ACCESSORIES FOUND

- 1) A 27" stump scribed ET in the NE location.
- 2) A 9" detached log scribed S23 ET in a burn pile. However, there is a rotted stump in the location, of the SE call, which is possibly from the log.
- 3) A 11" Ponderosa Pine that is healed over in the SW location.
- 4) A 14" stump scribed ET in the NW location.

PHOTO IDENTIFICATION DATA

Photo No. _____
Filed At. _____
Object Ident. _____
Ident. By _____
Signature

DESCRIBE CORNER LOCATION RELATIVE TO NEAR-BY FEATURES, ALSO HOW TO REACH CORNER

PLANE COORDINATE POSITION DATA

State _____ Zone _____
X _____
Y _____
Estab. By _____
Agency

Signature
Walt Miller

Title
PLS

Division
CS

Headquarters
SO

Date
6/87

CORNER RECORD (PERPETUATION)

MONUMENT: DESCRIBE NEW MONUMENT SET, OR WORK DONE TO PRESERVE EXISTING MONUMENT

Description of monument and accessories established to perpetuate the original location of this corner: Using trees 1, 3, and 4 and their respective record distances I did

MONUMENT STAMPED:

dist.-dist. intersects and set a 2 1/2" X 30" Brass Capped Steel Pipe rising 3", from which:

A 8" Ponderosa Pine bears N50°E at 14.3 ft., to a 60-Penny spike in the NW base, marked T17SR10ES14BT.

A 8" Ponderosa Pine bears S44°E at 56.6 ft., to a 60-Penny spike in the NE base, marked T17SR10ES23BT.

A 5" Ponderosa Pine bears S65 1/2°W at 16.0 ft., to a 60-Penny spike in the NW base, marked X BT.

A 1 1/2" Ponderosa Pine bears N46°W at 37.4 ft., to a 60-Penny spike in the NE base, marked T17SR10ES15BT.

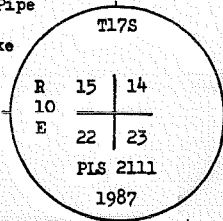

ACCES

TO PRESERVE EXISTING EVIDENCE

RESULTANTS to orig. trees:

- 1) N76 1/2°E at 25.4 ft.
- 2) Possible stump from tree - S44°E at 20.1 ft.
- 3) S36°W at 23.5 ft.
- 4) N26 1/2°W at 14.7 ft.

Work Done By Walt Miller Title PLS Date 6/87 State Registration No. 2111
 or Agency _____
 Certified Cor. Record Prepared? Yes No Filed At: Deschutes County Date 6/11/87

REMARKS

Original Survey By Thompson, Meldrum & Moore Date 11/24/1879

ORIGINAL DESCRIPTION:

Set post for corner to Secs 14, 15, 22 & 23 from which:

- A pine 22 in diam bears N 73° E 38 lks dist
- A pine 9 " " " N 30° W 21 " "
- A pine 9 " " " S 32° W 35 " "
- A pine 8 " " " S 48° E 30 " "

Index File No. 1763 T. _____ R. _____ M. _____ Tract or Surv. No. _____ Cor. N-17

Index
File No. 1763

CORNER RECORD (SEARCH)
(Ref. FSM 7151.4)

Tract or Survey No. _____
Cor. No. N-17

T 17 S. R. 10 E. R.D. Bend County Deschutes

Merid. _____ N.F. _____ State _____ NW Cor Sec. 23,

CORNER DIAGRAM

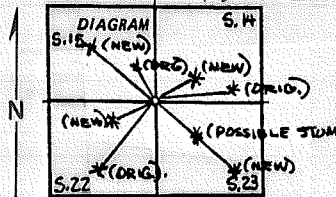

DESCRIBE CORNER MONUMENT FOUND

SF/NP

DESCRIBE BEARING TREES OR OTHER OFFICIAL ACCESSORIES FOUND

- 1) A 27" stump scribed BT in the NE location.
- 2) A 9" detached log scribed S23 BT in a burn pile. However, there is a rotted stump in the location, of the SE call, which is possibly from the log.
- 3) A 11" Ponderosa Pine that is healed over in the SW location.
- 4) A 14" stump scribed BT in the NW location.

PHOTO IDENTIFICATION DATA

Photo No. _____
Filed At. _____
Object Ident. _____
Ident. By _____
Signature

DESCRIBE CORNER LOCATION RELATIVE TO NEAR-BY FEATURES, ALSO HOW TO REACH CORNER

PLANE COORDINATE POSITION DATA

State _____ Zone _____
X _____
Y _____
Estab. By _____
Agency

Signature
Walt Miller

Title
PLS

Division
CS

Headquarters
SO

Date
6/87

CORNER RECORD (PERPETUATION)

MONUMENT: DESCRIBE NEW MONUMENT SET, OR WORK DONE TO PRESERVE EXISTING MONUMENT

Description of monument and accessories established to perpetuate the original location of this corner: Using trees 1, 3, and 4 and their respective record distances I did dist.-dist. intersects and set a 2 1/2" X 30" Brass Capped Steel Pipe rising 3", from which:
 A 8" Ponderosa Pine bears N50°E at 14.3 ft., to a 60-Penny spike in the NW base, marked T17SRLOES14ET.
 A 8" Ponderosa Pine bears S44 1/2°E at 56.6 ft., to a 60-Penny spike in the NE base, marked T17SRLOES23ET.
 A 5" Ponderosa Pine bears S65 1/2°W at 16.0 ft., to a 60-Penny spike in the NW base, marked X ET.
 A 13" Ponderosa Pine bears N46 1/2°W at 37.4 ft., to a 60-Penny spike in the NE base, marked T17SRLOES15ET.

MONUMENT STAMPED:

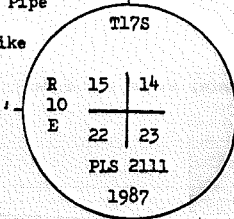

ACCES TO PRESERVE EXISTING EVIDENCE

9

RESULTANTS to orig. trees:

- 1) N76 1/2°E at 25.4 ft.
- 2) Possible stump from tree - S44°E at 20.1 ft.
- 3) S36°W at 23.5 ft.
- 4) N26 1/2°W at 14.7 ft.

Work Done By Walt Miller Title PLS Date 6/87 State Registration No. 2111
 or Agency

Certified Cor. Record Prepared? Yes No Filed At: Deschutes County Date 6/11/87

REMARKS

Original Survey By Thompson, Meldrum & Moore Date 11/24/1879

ORIGINAL DESCRIPTION:

Set post for corner to Secs 14.15. 22 & 23 from which:
 A pine 22 in diam bears N 73° E 38 lks dist
 A pine 9 " " " N 30° W 21 " "
 A pine 9 " " " S 32° W 35 " "
 A pine 8 " " " S 48° E 30 " "

Index File No. 1763 T. R. M. Tract or Surv. No. Cor. N-17

12

13

Index File No. 2563

CORNER RECORD (SEARCH)
(Ref. FSM 7151.4)

Tract or Survey No.

Cor. No. N-25

17 S. R. 10 E. R.D. SISTERS County DESCHUTES NE CN Sec 29
Merid. WILLAMETTE N.F. DESCHUTES State OREGON

SEE: N-01 T175 R11E

SP/NF

Index

File No.

2563

CORNER RECORD (SEARCH)

(Ref. FSM 7151.4)

Tract or

Survey No.

Cor.

No.

N-25

T 17 S. R. 10 E.

R.D.

SISTERS

County

DESCHUTES

NE 1/4

Sec 24

Merid.

WILLAMETTE

N.F.

DESCHUTES

State

OREGON

SEE: N-01 T17S R11E

SEE N-01

Index File No. 1365

CORNER RECORD (SEARCH) Contract or Survey No. _____
(Ref. FSM 7151.4)

Cor. No. P-13

T 17 S. R. 10 E. R.D. BEND

County DESCHUTES

E/4 Cor. of

Merid. Willamette

N.F. Deschutes

State Oregon

Section 21

CORNER DIAGRAM per legend

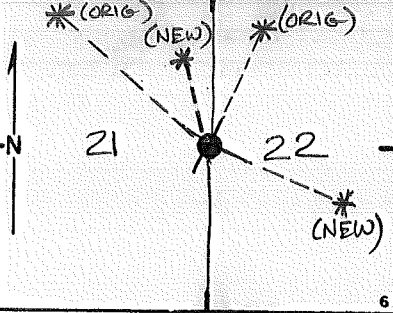

DESCRIBE CORNER MONUMENT FOUND

CRUISER POST (BROOKS TAGS)
12/86 - Walt Miller (PLS 2111) SF/NF

DESCRIBE BEARING TREES OR OTHER OFFICIAL ACCESSORIES FOUND

22" SNAG, N 27° W, @ 27°, SCBD " 1/4 SBT "
22" P. PINE, N 20° E, @ 24°, SCBD " " "

PHOTO IDENTIFICATION DATA

Photo No. _____
Filed At. _____
Object Ident. _____
Ident. By _____
Signature

DESCRIBE CORNER LOCATION RELATIVE TO NEAR-BY FEATURES, ALSO HOW TO REACH CORNER

150' EAST OF SPUR RD SIGN BOARD ON ROAD

CORNER LEGEND:

- FS or Contr. Unverified Other
- Searched For/Not Found
- Evidence Found/Accept.
- Permanent Mon. Set/Fd.

Searched By: S.C.

Title ST Division CS Headquarters SO Date 11-7-83

CORNER RECORD (PERPETUATION)

MONUMENTS: DESCRIBE NEW MONUMENT SET, OR WORK DONE TO PRESERVE EXISTING MONUMENT

12/86 (W. Miller) SET FROM DIST-DIST INTERSECT A
 2 1/2" x 30" ACAP RISING 4" ;

MONUMENT STAMPED

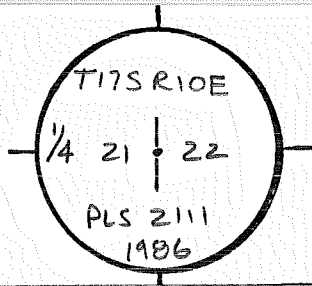

9

ACCESSORIES: DESCRIBE NEW BT'S WITNESS OBJECTS ETC. ESTABLISHED, OR WORK DONE TO PRESERVE EXISTING EVIDENCE

12/86 (W. Miller) SET:

AN 8" W. FIR bbs N17 1/2°W @ 118', to a 60-d spike in WSW base MKD 1/4S21BT
 " 8" " " S57 1/2°E @ 183', " " " " " SW " " 1/4S22BT

10

Work Done By W. Miller Title PLS Date 12/86 State Registration No. 2111
 or Agency
 Plat or Certified Cor. Record Prepared? Yes No Filed At: Des. Co. Surveyor's Office Date 12/18/86 "

History of Surveys, G.L.O., etc.
12" PINE, N20°E @ 244
20" PINE, N27°W @ 271

12

Index File No. 1365 T. 17S., R. 10 E., W.M.

Contract or Surv. No.

Cor. P. 13

13

Index
 File No. 2565 CORNER RECORD (SEARCH) (Ref. FSM 7151.4) Tract or Survey No. P-25
17 S. R. 10 E. R.D. SISTERS County DESCHUTES E/A Cor. Sec. 24
 Merid. WILLAMETTE N.F. DESCHUTES State OREGON W/A Cor. Sec. 12

SEE: P-01 T175 R11E

SF/WH

Index File No. 2565 CORNER RECORD (SEARCH) (Ref. FSM 7151.4) Tract or Survey No. _____ Cor. No. P-25
T 17 S. R. 10 E. R.D. SISTERS County DESCHUTES E 1/4 Sec. 29
Merid. WILLAMETTE N.F. DESCHUTES State OREGON W/4 Cor. Sec. 19

SEE: P-01 T17S R11E

SE/NE

Index File No. **0167**

(Ref. FSM 7151.4)

T. **17** S. R. **11** E.

R.D. **SISTERS** County **DESCHUTES**

State **OREGON**

SW 1/4 Sec 19

Merid. **WILLAMETTE**

N.F. **DESCHUTES**

State **OREGON**

NE 1/4 Sec 25

CORNER DIAGRAM

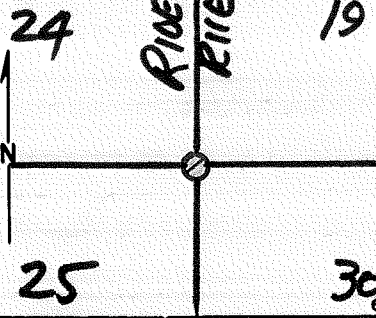

DESCRIBE CORNER MONUMENT FOUND

STONE, PAINTED, 18X12X8 LYING ON GROUND BESIDE KNITTING NEEDLE STUCK IN GROUND. NO MARKS ON STONE.

DESCRIBE BEARING TREES OR OTHER OFFICIAL ACCESSORIES FOUND

FR. STUMP WITH PIECE OF SCRIBED WOOD ON TOP HELD DOWN WITH A ROCK. STUMP DEFINITELY ~~KNITTING NEEDLE IN GROUND~~. IS NOT THE BT ~ AREA LOGGED OVER ~ POSSIBLE LOCATION IS A STUMPHOLE SE of STUMP, NW of STONE.

PHOTO IDENTIFICATION DATA

Photo No. _____
Filed At. _____
Object Ident. _____
Ident. By _____
Signature _____

DESCRIBE CORNER LOCATION RELATIVE TO NEAR-BY FEATURES, ALSO HOW TO REACH CORNER

± 500 FT. S. of ROAD
LOCATION NOT NEEDED for F.S. SO IT WILL HAVE TO BE SOMEONE ELSE'S PROBLEM!

PLANE COORDINATE POSITION DATA

State _____ Zone _____
X _____
Y _____
Estab. By _____
Agency _____

Signature **D.T. J.E.**

Title **S.A.**

Division _____

Headquarters _____

Date **10/79** **10/80**

CORNER RECORD (PERPETUATION)

MONUMENT: DESCRIBE NEW MONUMENT SET, OR WORK DONE TO PRESERVE EXISTING MONUMENT

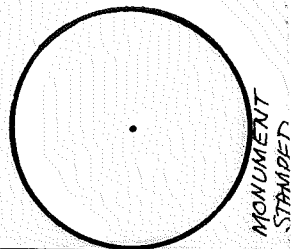

ACCESSORIES DESCRIBE NEW ST'S WITNESS OBJECTS ETC. ESTABLISHED, OR WORK DONE TO PRESERVE EXISTING EVIDENCE

Work Done By _____ Title _____ Date _____ State Registration No. or Agency _____

Certified Cor. Record Prepared? Yes No Filed At _____ Date _____

REMARKS

Index File No 0167 T. 17 S., R. 11 E., W. M. Tract or Surv. No. R-01

Index
File No. 0567

CORNER RECORD (SEARCH)
(Ref. FSM 7151.4)

Tract or
Survey No. _____ Cor.
No. R-05

T 17 S. R. 10 E. R.D. BEND County DESCHUTES NW COR
Merid. WM N.F. DNF State OR SEC 29

CORNER DIAGRAM

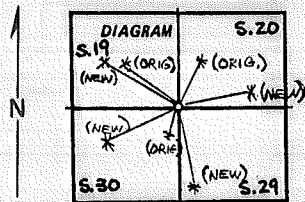

DESCRIBE CORNER MONUMENT FOUND

SF/NF

DESCRIBE BEARING TREES OR OTHER OFFICIAL ACCESSORIES FOUND

- 1) 6" and 12" twin pine snag in the NE location; faint scribing visible reading T17 S20 BT.
- 2) Wood in location of the SE tree, but rotted beyond recognition.
- 3) Down 12" log in the SW location with blaze; weathered badly and possible scribe marks.
- 4) Down rotted tree in the NW location with the root wad fairly intact and root charred in the ground. The main stem is rotted badly but found intact a blade with a scribed BT.

PHOTO IDENTIFICATION DATA

Photo No. _____
Filed At. _____
Object Ident. _____
Ident. By _____
Signature

PLANE COORDINATE POSITION DATA

State _____ Zone _____
X _____
Y _____
Estab. By _____
Agency

Signature
Walt Miller

Title
PLS

Division
CS

Headquarters
SO

Date
6/87

CORNER RECORD (PERPETUATION)

MONUMENT: DESCRIBE NEW MONUMENT SET, OR WORK DONE TO PRESERVE EXISTING MONUMENT

Set 2½" X 30" Aluminum Capped

Aluminum Pipe rising 2" using record bearings and distances from 1, 3, and 4 above, from which:

MONUMENT STAMPED:

A 5" Lodgepole Pine bears N79½°E at 42.7 ft., to a 60-Penny spike in the NW base, marked X BT.

A 8" Lodgepole Pine bears S13½°E at 50.3 ft., to a 60-Penny spike in the E base, marked T17SR10ES29BT.

A 7" Lodgepole Pine bears S66°W at 42.7 ft., to a 60-Penny spike in the SE base, marked T17SR10ES30BT.

A 4" Lodgepole Pine bears N53°W at 40.2 ft., to a 60-Penny spike in the SW base, marked X BT.

RESULTANTS to original locations -- N30°E at 34.3' to NE tree, N42°W at 38.0' to NW tree, and S35°W at 10.8' to SW tree.

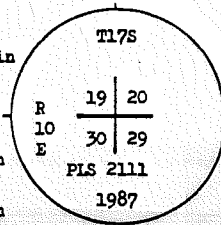

ACCESSO

IVE EXISTING EVIDENCE

Work Done By Walt Miller Title PLS Date 6/07 State Registration No. 2111
 or Agency

Certified Cor. Record Prepared? Yes No Filed At: Deschutes Date 6/11/87

REMARKS

Original Survey By Thompson, Meldrum & Moore Date 11/29/1879

ORIGINAL DESCRIPTION:

Set post for corner to Secs 19, 20, 29 & 30 from which:

A pine 10 in diam bears N 30° E 51 lks dist
 A pine 10 " " " N 44° W 59 " "
 A pine 6 " " " S 28° W 16 " "
 A pine 14 " " " S 73° E 39 " "

Index File No. 0567 T. R. M. Tract or Surv. No. Cor. R-05

Index
File No. 1167

CORNER RECORD (SEARCH) Contract or
(Ref. FSM 7151.4) Survey No. _____

Cor. No. R-11

T 17 S. R. 10 E. R.D. BEND

County DESCHUTES

W/4 Cor. of

Merid. Willamette

N.F. Deschutes

State Oregon

Section 28

CORNER DIAGRAM per legend

DESCRIBE CORNER MONUMENT FOUND

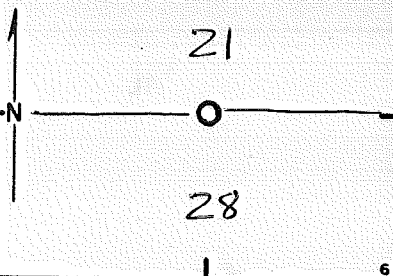

S.F.N.F.

DESCRIBE BEARING TREES OR OTHER OFFICIAL ACCESSORIES FOUND

HEAVY CAT ACTIVITY! LOTS OF ROTTED BURNED STUMPS

PHOTO IDENTIFICATION DATA

Photo No. _____
Filed At. _____
Object Ident. _____
Ident. By _____
Signature

DESCRIBE CORNER LOCATION RELATIVE TO NEAR-BY FEATURES, ALSO HOW TO REACH CORNER

CORNER LEGEND:
FS or Unverified
Contr. Other
○ ◇ Searched For/Not Found
⊗ ⊗ Evidence Found/Accept.
● ◆ Permanent Mon. Set/Fd.

Searched By: SCHAMBERLAIN Title ST

Division CS

Headquarters SO

Date 6-13-84

CORNER RECORD (PERPETUATION)

MONUMENTS: DESCRIBE NEW MONUMENT SET, OR WORK DONE TO PRESERVE EXISTING MONUMENT

MONUMENT STAMPED

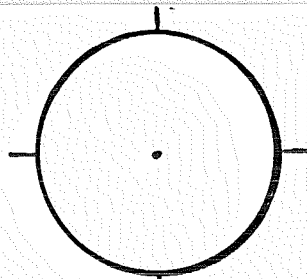

ACCESSORIES: DESCRIBE NEW BT'S WITNESS OBJECTS ETC. ESTABLISHED, OR WORK DONE TO PRESERVE EXISTING EVIDENCE

Work Done By _____ Title _____ Date _____ State Registration No. _____
or Agency _____
Plat or Certified Cor. Record Prepared? Yes No Filed At: _____ Co. Surveyor's Office Date _____

History
of
Surveys,
G.L.O.,
etc.

POST
7" PINE N 35° E @ 13⁹
7" " S 18° E @ 36

Index File No. 1167 T. 17 S., R. 10 E., W.M.

Contract or Surv. No.

Cor. R-11

USDA-FOREST SERVICE

Index
File No. 1367
T 17 S R. 10 E
Merid. Wm

CORNER RECORD (SEARCH)

(Ref. FSM 7151.4)

R.D. Bend County DeSoto
N.F. DNF State OL

Tract or Survey No. _____
Cor. No. R-13

NW S.27

CORNER DIAGRAM

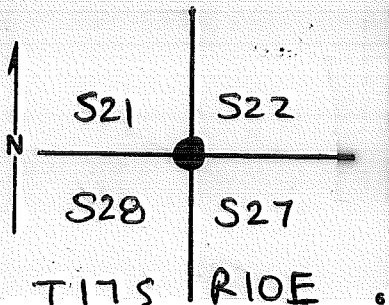

DESCRIBE CORNER MONUMENT FOUND

FOUND WELL EMBEDDED MOUND OF STONE. NO EVIDENCE OF BEARING TREES
OLD BLAZED LINES OF DIFFERENT VINTAGES ALIGN WITH THIS POSITION
I ACCEPT THIS AS BEST AVAILABLE EVIDENCE OF ORIGINAL POSITION.

DESCRIBE BEARING TREES OR OTHER OFFICIAL ACCESSORIES FOUND

PHOTO IDENTIFICATION DATA

Photo No. _____
Filed At. _____
Object Ident. _____
Ident. By _____
Signature

DESCRIBE CORNER LOCATION RELATIVE TO NEAR-BY FEATURES, ALSO HOW TO REACH CORNER

PLANE COORDINATE POSITION DATA

State _____ Zone _____
X _____
Y _____
Estab. By _____
Agency

Signature

Title

Division

Headquarters

Date

FS-7100-52 (3/68)

Don Gresdal

PLS

6/19/02

CORNER RECORD (PERPETUATION)

MONUMENT: DESCRIBE NEW MONUMENT SET, OR WORK DONE TO PRESERVE EXISTING MONUMENT

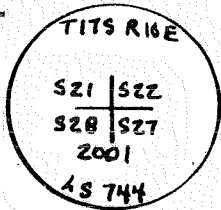

SET 2" IRON PIPE WITH BRASS CAP. SCRIBED NEW B.T.'s AS FOLLOWS:
 8" LODGEPOLE PINE N30°47'E, 15 1/4 FT. SCRIBED TITS RIDE S22 BT
 9" " " S32°56'E, 33 1/2 FT. " TITS RIDE S27 BT
 9" " " S30°14'W, 10 1/2 FT. " TITS RIDE S28 BT
 10" " " N55°23'W, 11 1/2 FT. " TITS RIDE S21 BT

WORK DONE TO PRESERVE EXISTING EVIDENCE

MEASUREMENTS TO CENTER OF TREE AT ROOT CROWN
 BEARINGS ARE TRUE, BY SOLAR OBSERVATION
 A BRASS DISC STAMPED "LS 744" IS NAILED IN LOWER BLAZE.

Work Done By Don Gresdal Title PLS Date 6/19/02 State Registration No. 744
 or Agency

Certified Cor. Record Prepared? Yes No Filed At: _____ Date _____

REMARKS

G.L.O. SURVEY IN 1879 BY THOMPSON, MELDRUM AND MOORE
 SET WOODEN POST FOR CORNER
 " BEARING TREES FOR REFERENCE
 12" PINE N78°E, 17 LINKS
 10" " N22°W, 11 "
 16" " S45°W, 9 "
 8" " S65°E, 12 "

Index File No. 1367 T. _____ R. _____ M. _____ Tract or Surv. No. _____ Cor. R-13

Index
File No. 1567

CORNER RECORD (SEARCH)

(Ref. FSM 7151.4)

Tract or Survey No. _____
Cor. No. R-15

T 17 S. R. 10 E. R.D. BEND County DESCHUTES S/4

Merid. WM N.F. DNF State OR S.22

CORNER DIAGRAM

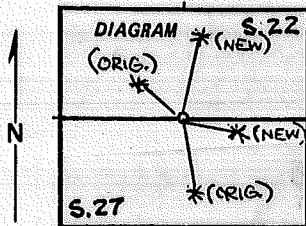

DESCRIBE CORNER MONUMENT FOUND

SF/NF

DESCRIBE BEARING TREES OR OTHER OFFICIAL ACCESSORIES FOUND

- 1) 5' high stump in NW location, marked 1/4SBT.
- 2) Stump in SE location, marked BT.

PHOTO IDENTIFICATION DATA

Photo No. _____

Filed At. _____

Object Ident. _____

Ident. By _____

Signature

PLANE COORDINATE POSITION DATA

State _____ Zone _____

X _____

Y _____

Estab. By _____

Agency

Signature
Walt Miller

Title
PLS

Division
CS

Headquarters
SO

Date
12/86

CORNER RECORD (PERPETUATION)

MONUMENT: DESCRIBE NEW MONUMENT SET, OR WORK DONE TO PRESERVE EXISTING MONUMENT

Description of monument and accessories established to perpetuate the original location of this corner:

MONUMENT STAMPED:

Using record calls from each tree, I set a 2½" X 30" Aluminum Pipe Aluminum Cap rising 3", from which:

A 9" Ponderosa Pine bears S81°E at 16.6 ft., to a 60-Penny spike in the SSW base, marked 1/4S27BT.

A 12" Ponderosa Pine bears N13¼°E at 39.1 ft., to a 60-Penny spike in the W base, marked 1/4S22BT.

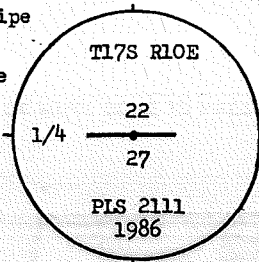

9
STANDING EVIDENCE

RESULTING DATA:

- 1) Orig. SE tree bears S14°E at 24.3'.
- 2) Orig. NW tree bears N41°W at 15.4'.

Work Done By Walt Miller Title PLS Date 12/86 State Registration No. 2111
or Agency _____
Certified Cor. Record Prepared? Yes No Filed At: Des Co, Date 12/18/86

REMARKS

Original Survey By Thompson, Meldrum & Moore Date 11/29/1879

ORIGINAL DESCRIPTION:

Set post for 1/4 Sec corner from which:

- A pine 12 in diam bears N45°W 23 lks dist
A pine 16 " " " S17°E 36 " "

Index File No. 1567 T. 17 R. 10 M.

Tract or Surv. No.

Cor. R-15 12
13

Index File No. 1967

CORNER RECORD (SEARCH) Contract or Survey No. (Ref. FSM 7151.4)

Cor. No. R-19

T 17 S. R. 10 E. R.D. BEND

County DESCHUTES

Cor. of 5/4

Merid. Willamette

N.F. Deschutes

State Oregon

Section 23

CORNER DIAGRAM per legend

DESCRIBE CORNER MONUMENT FOUND

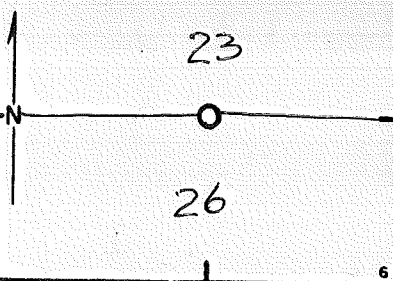

S.F.N.F.

DESCRIBE BEARING TREES OR OTHER OFFICIAL ACCESSORIES FOUND

HEAVY LOGGING ACTIVITY & CAT ROADS. A FEW BIG STUMPS, NO SCRIBING FOUND.

PHOTO IDENTIFICATION DATA

Photo No. _____
Filed At. _____
Object Ident. _____
Ident. By _____
Signature _____

DESCRIBE CORNER LOCATION RELATIVE TO NEAR-BY FEATURES, ALSO HOW TO REACH CORNER

900' WEST OF SIGN BOARD

CORNER LEGEND:

FS or Unverified
Contr. Other

Searched For/Not Found

Evidence Found/Accept.

Permanent Mon. Set/Fd.

Searched By: S. CHAMBERLIN

Title S.T. Division CS Headquarters SO

Date 6-14-84

CORNER RECORD (PERPETUATION)

MONUMENTS: DESCRIBE NEW MONUMENT SET, OR WORK DONE TO PRESERVE EXISTING MONUMENT

MONUMENT STAMPED

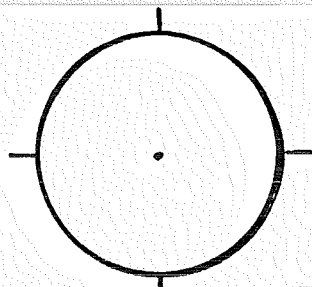

ACCESSORIES: DESCRIBE NEW BT'S WITNESS OBJECTS ETC. ESTABLISHED, OR WORK DONE TO PRESERVE EXISTING EVIDENCE

Work Done By _____ Title _____ Date _____ State Registration No. or Agency _____
Plat or _____
Certified Cor. Record Prepared? Yes No Filed At: _____ Co. Surveyor's Office Date _____

History of Surveys, G.L.O., etc.
36" PINE N40°E @ 25'⁷
12" " S15°E @ 32'⁶

Index File No. 1967 T. 17 S., R. 10 E., W.M. Contract or Surv. No. Cor. R-19

Index
File No. 2167

CORNER RECORD (SEARCH)

(Ref. FSM 7151.4)

Tract or Survey No. _____ Cor. No. R-21

T 17 S. R. 10 E. R.D. BEND County DESCHUTES

Merid. WM N.F. DNF State OR NW COR S.25

CORNER DIAGRAM

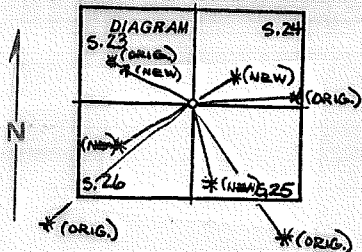

DESCRIBE CORNER MONUMENT FOUND

SF/NF

DESCRIBE BEARING TREES OR OTHER OFFICIAL ACCESSORIES FOUND

Description of corner evidence found:

- 1) 12" Ponderosa Pine, healed over in the NE location.
- 2) 26" rotted stump scribed PT, in the SE location.
- 3) 30" rotted and burned stump scribed T in the SW location.
- 4) 24" rotted stump scribed ET, in the NW location.

PHOTO IDENTIFICATION DATA

Photo No. _____
Filed At. _____
Object Ident. _____
Ident. By _____

Signature

PLANE COORDINATE POSITION DATA

State _____ Zone _____
X _____
Y _____
Estab. By _____

Agency

Signature
Walt Miller

Title PLS Division CS Headquarters SO

Date 6/87

CORNER RECORD (PERPETUATION)

MONUMENT: DESCRIBE NEW MONUMENT SET, OR WORK DONE TO PRESERVE EXISTING MONUMENT

Description of monument and accessories established to perpetuate the original location of this corner: By dist-dist inresects using record MONUMENT STAMPED:

distances, I set a 2 1/2" X 30" Aluminum Capped Aluminum Pipe rising 6" in a rock circle, from which:

A 15" Ponderosa Pine bears N58°E at 13.4 ft., to a 60-Penny spike in the SE base, marked T17SR10ES24ET.

A 9" Ponderosa Pine bears S16 1/2°E at 34.8 ft., to a 60-Penny spike in the NE base, marked T17SR10ES25ET.

ACCESS:

A 7" Ponderosa Pine bears S55 1/2°W at 36.6 ft., to a 60-Penny spike in the NW base, marked T17SR10ES26ET.

A 11" Ponderosa Pine bears N52 1/2°W at 53.2 ft., to a 60-Penny spike in the NE base, marked T17SR10ES23ET.

RESULTANTS to original trees:

- 1) N81°E at 47.0 ft.
- 2) S32°E at 79.5 ft.
- 3) S44°W at 79.9 ft.
- 4) N52 1/2°W at 57.9 ft.

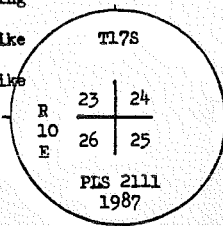

○ PRESERVE EXISTING EVIDENCE

Work Done By Walt Miller Title PLS Date 6/87 State Registration No. 2111
 or Agency _____
 Certified Cor. Record Prepared? Yes No Filed At: Des. County Date 6/11/87

REMARKS
 Original Survey By Thompson, Meldrum & Moore Date 11/24/1879

ORIGINAL DESCRIPTION:

Set post for corner to Secs 23, 24 25 & 26

- A pine 8 in diam bears N 77° E 69 lks dist
 A pine 30 " " " N 57° W 87 " "
 A pine 34 " " " S 39° W 120 " "
 A pine 28 " " " S 36° E 120 " "

Index File No. 2167

T.

R.

M.

Tract or Surv. No.

Cor. R-21

12

13

Index File No. 2367

CORNER RECORD (SEARCH) Contract or Survey No. _____
(Ref. FSM 7151.4)

Cor. No. R-23

T 17 S. R. 10 E. R.D. BEND

County DESCHUTES

5/4 Cor. of

Merid. Willamette

N.F. Deschutes

State Oregon

Section 24

CORNER DIAGRAM per legend

DESCRIBE CORNER MONUMENT FOUND

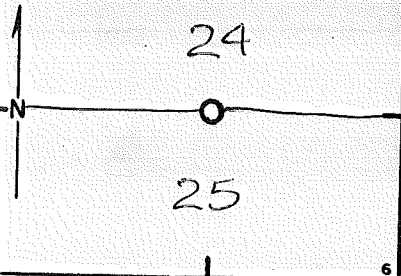

S.F.N.F.

DESCRIBE BEARING TREES OR OTHER OFFICIAL ACCESSORIES FOUND

HEAVY LOGGING & CAT ACTIVITY

PHOTO IDENTIFICATION DATA

Photo No. _____
Filed At. _____
Object Ident. _____
Ident. By _____
Signature

DESCRIBE CORNER LOCATION RELATIVE TO NEAR-BY FEATURES, ALSO HOW TO REACH CORNER

PACED & COMPASS WEST FROM SEC. COR

CORNER LEGEND:

- FS or Unverified
- Contr. Other
- Searched For/Not Found
- Evidence Found/Accept.
- Permanent Mon. Set/Fd.

Searched By S. CHAMBERLIN

Title S.T.

Division CS

Headquarters SO

Date 6-19-89

CORNER RECORD (PERPETUATION)

MONUMENTS: DESCRIBE NEW MONUMENT SET, OR WORK DONE TO PRESERVE EXISTING MONUMENT

MONUMENT STAMPED

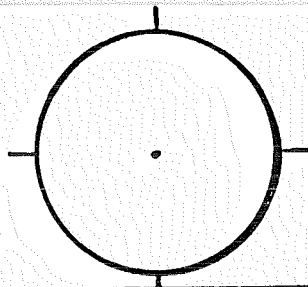

9

ACCESSORIES: DESCRIBE NEW BT'S WITNESS OBJECTS ETC. ESTABLISHED, OR WORK DONE TO PRESERVE EXISTING EVIDENCE

10

Work Done By _____ Title _____ Date _____ State Registration No. or Agency _____

Plat or Certified Cor. Record Prepared? Yes No Filed At: _____ Co. Surveyor's Office Date _____

11

History of Surveys, G.L.O., etc.

24" PINE S43°E @ 33°

40" PINE N48°W @ 34°

12

Index File No. 2367 T. 17 S., R. 10 E., W.M.

Contract or Surv. No

Cor. R-23

13

Index File No. 2567

CORNER RECORD (SEARCH) (Ref. FSM 7151.4) Contract or Survey No. _____

Cor. No. R-25

T 17 S. R. 10+11 E. R.D. BEND

County DESCHUTES

SE Cor. of

Merid. Willamette

N.F. Deschutes

State Oregon

Section 24

CORNER DIAGRAM per legend

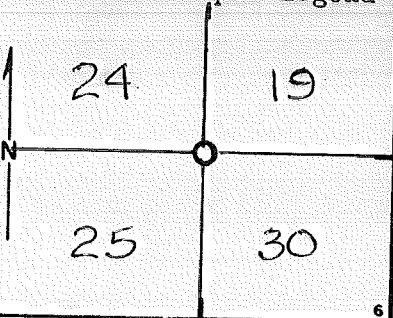

DESCRIBE CORNER MONUMENT FOUND

S.F.N.F.

DESCRIBE BEARING TREES OR OTHER OFFICIAL ACCESSORIES FOUND

LOCATION TAG

HEAVY LOGGING & CAT WORK

PHOTO IDENTIFICATION DATA

Photo No. _____
Filed At. _____
Object Ident. _____
Ident. By _____
Signature

DESCRIBE CORNER LOCATION RELATIVE TO NEAR-BY FEATURES, ALSO HOW TO REACH CORNER

CORNER LEGEND:

- FS or Contr. Unverified Other
- Searched For/Not Found
- Evidence Found/Accept.
- Permanent Mon. Set/Fd.

Searched By: S. CHAMBERLIN

Title S.T.

Division CS

Headquarters SO

Date 6-19-84

CORNER RECORD (PERPETUATION)

MONUMENT: DESCRIBE NEW MONUMENT SET, OR WORK DONE TO PRESERVE EXISTING MONUMENT

MONUMENT STAMPED

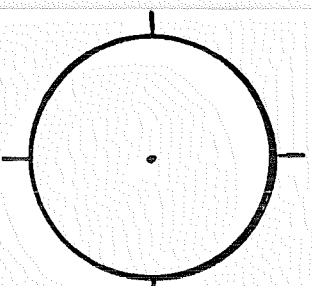

ACCESSORIES: DESCRIBE NEW BT'S WITNESS OBJECTS ETC. ESTABLISHED, OR WORK DONE TO PRESERVE EXISTING EVIDENCE

Work Done By _____ Title _____ Date _____ State Registration No. or Agency _____
Plat or Certified Cor. Record Prepared? Yes No Filed At: _____ Co. Surveyor's Office Date _____

History of Surveys, G.L.O., etc.
STONE 17 x 8 x 6
12" PINE N 62° W @ 12'

Index File No. 2567 T. 17 S., R. 10411 E., W.M. Contract or Surv. No. Cor. R-25

Index
File No. 0969

CORNER RECORD (SEARCH). Contract or
(Ref. FSM 7151.4) Survey No. _____

Cor. No. T-09

T 17 S. R. 10 E.

R.D. BEND

County DESCHUTES

W/4 Cor. of

Merid. Willamette

N.F. Deschutes

State Oregon

Section 28

CORNER DIAGRAM per legend

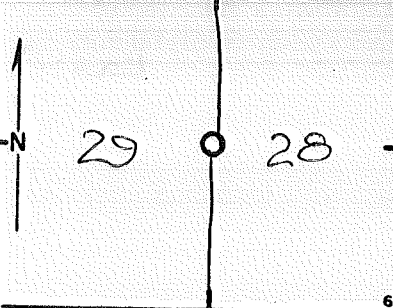

DESCRIBE CORNER MONUMENT FOUND

S.F.N.F.

DESCRIBE BEARING TREES OR OTHER OFFICIAL ACCESSORIES FOUND

TREES THAT ARE DOWN ARE BURNED & DECAYED
REAL BAD

PHOTO IDENTIFICATION DATA

Photo No. _____
Filed At. _____
Object Ident. _____
Ident. By _____
Signature

DESCRIBE CORNER LOCATION RELATIVE TO NEAR-BY FEATURES, ALSO HOW TO REACH CORNER

CHAINED + COMPASS NORTH FROM SEC. CORNER

CORNER LEGEND:

- FS or Unverified
- Contr. Other
- Searched For/Not Found
- Evidence Found/Accept.
- Permanent Mon. Set/Fd.

Searched By S. CHAMBERLIN

Title S.T.

Division CS

Headquarters SO

Date 6-18-84

CORNER RECORD (PERPETUATION)

MONUMENT: DESCRIBE NEW MONUMENT SET, OR WORK DONE TO PRESERVE EXISTING MONUMENT

MONUMENT STAMPED

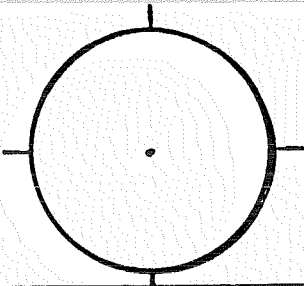

9

ACCESSORIES : DESCRIBE NEW BT'S WITNESS OBJECTS ETC. ESTABLISHED, OR WORK DONE TO PRESERVE EXISTING EVIDENCE

10

Work Done By _____ Title _____ Date _____ State Registration No. or Agency _____

Plat or Certified Cor. Record Prepared? Yes No Filed At: _____ Co. Surveyor's Office Date _____

11

History of Surveys, G.L.O., etc.
10" PINE S12°E @ 7²
9" " S53°W @ 17¹

12

Index File No. 0969 T 17 S., R. 10 E., W.M. Contract or Surv. No. Cor. T-09

13

Index File No. 1369

CORNER RECORD (SEARCH) (Ref. FSM 7151.4) Contract or Survey No. _____

Cor. No. T-13

T 17 S. R. 10 E. R.D. BEND

County DESCHUTES

W/4 Cor. of

Merid. Willamette

N.F. Deschutes

State Oregon

Section 27

CORNER DIAGRAM per legend

DESCRIBE CORNER MONUMENT FOUND

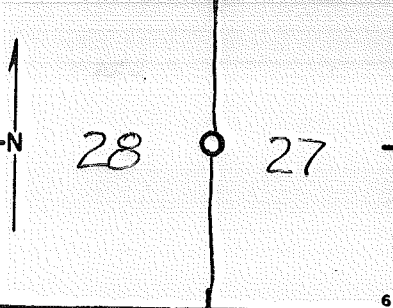

S.F.N.F.

DESCRIBE BEARING TREES OR OTHER OFFICIAL ACCESSORIES FOUND

BROOKES TAG

HEAVY WOOD CUTTERS AND LOGGING

PHOTO IDENTIFICATION DATA

Photo No. _____
Filed At. _____
Object Ident. _____
Ident. By _____
Signature

DESCRIBE CORNER LOCATION RELATIVE TO NEAR-BY FEATURES, ALSO HOW TO REACH CORNER

CORNER LEGEND:

- FS or Contr. Unverified Other
- Searched For/Not Found
- Evidence Found/Accept.
- Permanent Mon. Set/Fd.

Searched By: S. CHAMBERLIN

Title ST. Division CS Headquarters SO

Date 6-13-84

CORNER RECORD (PERPETUATION)

MONUMENT: DESCRIBE NEW MONUMENT SET, OR WORK DONE TO PRESERVE EXISTING MONUMENT

MONUMENT STAMPED

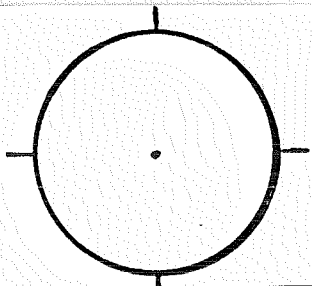

9

ACCESSORIES : DESCRIBE NEW BT'S WITNESS OBJECTS ETC. ESTABLISHED, OR WORK DONE TO PRESERVE EXISTING EVIDENCE

10

Work Done By _____ Title _____ Date _____ State Registration No. or Agency _____
Plat or Certified Cor. Record Prepared? Yes No Filed At: _____ Co. Surveyor's Office Date _____

11

History of Surveys, G.L.O., etc. _____

12

Index File No. 1369 T. 17 S., R. 10 E., W.M. Contract or Surv. No. Cor. T-13

13

USDA-FOREST SERVICE

Index

File No. 2569

T. 17 S. R. 10

Merid. WILLAMETTE

CORNER RECORD (SEARCH)

(Ref. FSM 7.151.4)

E. R.D. BEND

N.F. DESCHUTES

County DESCHUTES

State OREGON

Tract or Survey No.

Cor. No. T-25
T-69

COR. of SEC.

COR. of SEC.

CORNER DIAGRAM PER LEGEND

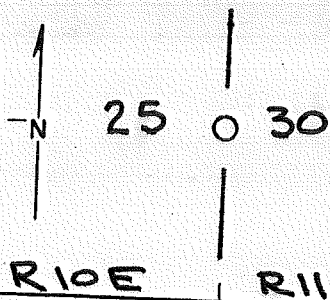

DESCRIBE CORNER MONUMENT FOUND

Searched For Nothing Found.

DESCRIBE BEARING TREES OR OTHER OFFICIAL ACCESSORIES FOUND

S.F.N.F

PHOTO IDENTIFICATION DATA

Photo No. _____

Filed At. _____

Object Ident. _____

Ident. By _____

Signature

DESCRIBE CORNER LOCATION RELATIVE TO NEAR-BY FEATURES, ALSO HOW TO REACH CORNER

Corner Legend:

Searched for/Not Found

Evidence Found/Accept.

Permanent Monument

Signature H.C.P.

Title

Division

Headquarters BEND

Date 5/8/07 D-7100-52 (3/75)

CORNER RECORD (PERPETUATION)

MONUMENT DESCRIBE NEW MONUMENT SET, OR WORK DONE TO PRESERVE EXISTING MONUMENT

MONUMENT STAFF

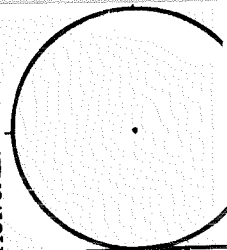

ACCESSORIES DESCRIBE NEW B¹/₂ WITNESS OBJECTS ETC. ESTABLISHED, OR WORK DONE TO PRESERVE EXISTING EVIDENCE

Work Done By _____ Title _____ Date _____ State Registration No. or Agency _____

PLAT PREPARED OR
Certified Cor. Record Prepared ? Yes No Filed At:

Co. SURVEYOR'S OFFICE Date

REMARKS

Index File No. T. S., R. E., W.M. Tract or Surv. No. Cor.

Index File No. 0971

CORNER RECORD (SEARCH)

(Ref. FSM 7151.4)

T 17 S. R. 10 E. R.D. BEND

Tract or Survey No. _____

Cor. No. V-09

Merid. WM

N.F. DNF

County DESCHUTES

NW COR
Sec. 33

State _____

CORNER DIAGRAM

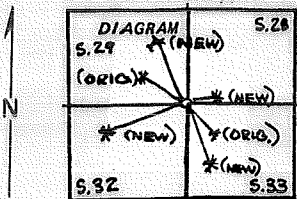

DESCRIBE CORNER MONUMENT FOUND

SF/NF

DESCRIBE BEARING TREES OR OTHER OFFICIAL ACCESSORIES FOUND 2

- 1) Down rotted log in the SE location, marked R10E S33 BT.
- 2) Down rotted log in the NW location, marked 17S S29 BT.

No sign of the NE or SW trees.

PHOTO IDENTIFICATION DATA 6

Photo No. _____

Filed At. _____

Object Ident. _____

Ident. By _____

Signature

7

PLANE COORDINATE POSITION DATA

State _____ Zone _____

X _____

Y _____

Estab. By _____

Agency

8

DESCRIBE CORNER LOCATION RELATIVE TO NEAR-BY FEATURES, ALSO HOW TO REACH CORNER 3

Signature
Walt Muller

Title
PLS

Division
CS

Headquarters
SO

Date
6/87

FS-7100-52 (3/68)

4

CORNER RECORD (PERPETUATION)

MONUMENT: DESCRIBE NEW MONUMENT SET, OR WORK DONE TO PRESERVE EXISTING MONUMENT

Description of monument and accessories | established to perpetuate the original location of this corner: Using a dist.-dist. intersect from the two found trees, I set a 2 1/2" X 30" aluminum Capped Aluminum Pipe from which:

A 5" White Fir bears N80°E at 3.0 ft., to a 60-Penny spike in the SE base, marked X BT.

A 5" White Fir bears S22°E at 26.7 ft., to a 60-Penny spike in the NE base, marked T17SR10ES33BT.

A 6" Hemlock bears S64 1/2°W at 30.7 ft., to a 60-Penny spike in the NW base, marked T17SR10ES32BT.

A 7" White Fir bears N23 1/2°W at 50.4 ft., to a 60-Penny spike in the SW base, marked T17SR10ES29BT.

RESULTANTS to orig. trees from corner:

- 1) S33°E at 10.6 ft.
- 2) N51°W at 11.2 ft.

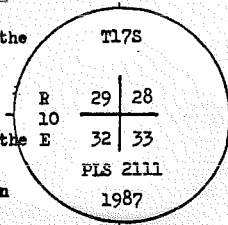

TO PRESERVE EXISTING EVIDENCE

ACC

9

10

Work Done By Walt Miller Title PLS Date 6/87 State Registration No. or Agency 2111
 Certified Cor. Record Prepared? Yes No Filed At: Deschutes County Date 6/11/87

11

REMARKS

Original Survey By Thompson, Meldrum & Moore Date 11/29/1879

ORIGINAL DESCRIPTION:

Set post for Corner to Secs 28.29 32 & 33 from which:

- A pine 14 in diam bears N 38° E 43 lks dist
- A pine 7 " " " N 48° W 17 " "
- A pine 9 " " " S 48° W 12 " "
- A pine 6 " " " S 37° E 16 " "

12

Index File No. 0971 T. R. M. Tract or Surv. No. Cor. V-09

13

Index File No. 1371

CORNER RECORD (SEARCH). Contract or Survey No. (Ref. FSM 7151.4)

Cor. No. V-13

T 17 S. R. 10 E. R.D. BEND

County DESCHUTES

SE Cor. of

Merid. Willamette

N.F. Deschutes

State Oregon

Section 28

CORNER DIAGRAM per legend

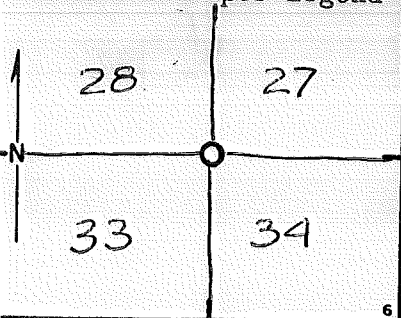

DESCRIBE CORNER MONUMENT FOUND

S.F.NF

DESCRIBE BEARING TREES OR OTHER OFFICIAL ACCESSORIES FOUND

HEAVY WOOD CUTTERS AND LOGGING
EVERYTHING ON GROUND ROTTED BAD!

PHOTO IDENTIFICATION DATA

Photo No. _____
Filed At. _____
Object Ident. _____
Ident. By _____
Signature

DESCRIBE CORNER LOCATION RELATIVE TO NEAR-BY FEATURES, ALSO HOW TO REACH CORNER

CORNER LEGEND:

- FS or Unverified
- Contr. Other
- Searched For/Not Found
- Evidence Found/Accept.
- Permanent Mon. Set/Fd.

Searched By: S. CHAMBERLIN

Title S.T. Division CS Headquarters SO Date 6-13-84

CORNER RECORD (PERPETUATION)

MONUMENT: DESCRIBE NEW MONUMENT SET, OR WORK DONE TO PRESERVE EXISTING MONUMENT

MONUMENT STAMPED

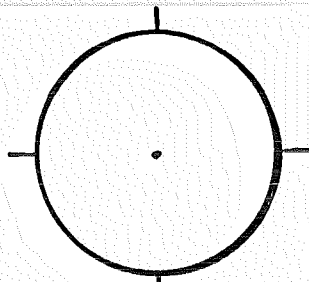

9

ACCESSORIES : DESCRIBE NEW BT'S WITNESS OBJECTS ETC. ESTABLISHED, OR WORK DONE TO PRESERVE EXISTING EVIDENCE

10

Work Done By _____ Title _____ Date _____ State Registration No. _____
or Agency _____

Plat or Certified Cor. Record Prepared? Yes No Filed At: _____ Co. Surveyor's Office Date _____

11

History
of
Surveys,
G.L.O.,
etc.

12

Index File No. 1371 T. 17 S., R. 10 E., W.M.

Contract or Surv. No.

Cor. V-13

13

USDA-FOREST SERVICE

Index
 File No. 1571
 T 17 S. R. 10 E
 Merid. W.M.T.

CORNER RECORD (SEARCH)

(Ref. FSM 7151.4)

R.D. Bond County Deschutes
 N.F. DNF State OR

Tract or Survey No. _____
 Cor. No. V-15
5/4 Sec. 27

CORNER DIAGRAM

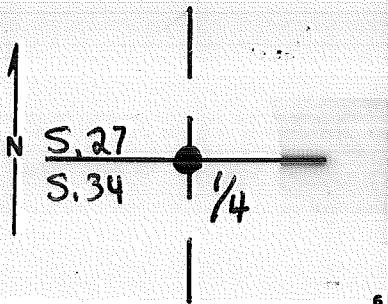

DESCRIBE CORNER MONUMENT FOUND

FOUND MOUND OF STONE. FOUND DOWN B.T. (VISIBLE SCRIBING) $S58^{\circ}E, 13^{\circ}E$ FT.

PHOTO IDENTIFICATION DATA

Photo No. _____
 Filed At. _____
 Object Ident. _____
 Ident. By _____
Signature

DESCRIBE CORNER LOCATION RELATIVE TO NEAR-BY FEATURES, ALSO HOW TO REACH CORNER

PLANE COORDINATE POSITION DATA

State _____ Zone _____
 X _____
 Y _____
 Estab. By _____
Agency

Signature

Don Crestel

Title

PLS

Division

Headquarters

Date

6/19/02

FS-7100-52 (3/68)

CORNER RECORD (PERPETUATION)

MONUMENT: DESCRIBE NEW MONUMENT SET, OR WORK DONE TO PRESERVE EXISTING MONUMENT

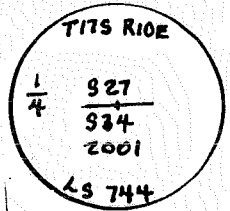

SET 2" IRON PIPE WITH 2 1/2" BRASS CAP, AND SCRIBED BEARING TREES AS FOLLOWS:

- 4" LODGEPOLE PINE N12°35'W, 127 FT. SCRIBED X BT
- 11" " " N19°28'E, 303 FT. " 1/4 S27 BT
- 9" " " S30°53'E, 458 FT. " 1/4 S34 BT
- 7" WHITE FIR " S24°45'W, 402 FT. " X BT

PRESERVE EXISTING EVIDENCE

MEASURED TO CENTER OF TREE AT ROOT CROWN. A BRASS DISC STAMPED "LS 744" IS NAILED IN LOWER BLAZE.

BEARINGS ARE TRUE, BASED ON A SOLAR OBSERVATION

Work Done By Don Greidel Title PLC Date 6/19/02 State Registration No. 744
 or Agency

Certified Cor. Record Prepared? Yes No Filed At: Des. Co. Date _____

REMARKS

G.L.O. SURVEY IN 1879 BY THOMPSON, MELDRUM AND MOORE
 SET WOODEN POST FOR 1/4 CORNER
 SCRIBED BEARING TREES FOR REFERENCE:
 5" PINE BEARS N33°W, 24 LINKS
 6" " " S58°E, 20 LINKS

Index File No. 1571 T. _____ R. _____ M. _____ Tract or Surv. No. _____ Cor. _____

GPO: 1986 O-439-095 V-15

USDA-FOREST SERVICE

Index
File No. 1771

CORNER RECORD (SEARCH)

(Ref. FSM 7151.4)

Tract or Survey No. _____ Cor. No. V-17

T 17 S R. 10 E
Merid. W

R.D. Bend County DeWitt
N.F. DNF State OR NW S135

CORNER DIAGRAM

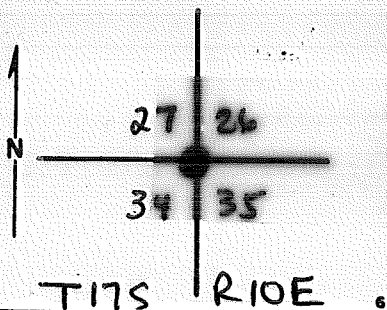

DESCRIBE CORNER MONUMENT FOUND

FOUND MOUND OF STONE. FOUND STUMP N50°E, FOUND STUMP N41°22'W, FOUND SNAG S13°20'W, ALL WITH VISIBLE SCRIBING AND AT RECORD DISTANCES.

PHOTO IDENTIFICATION DATA

Photo No. _____
Filed At. _____
Object Ident. _____
Ident. By _____
Signature

DESCRIBE CORNER LOCATION RELATIVE TO NEAR-BY FEATURES, ALSO HOW TO REACH CORNER

PLANE COORDINATE POSITION DATA

State _____ Zone _____
X _____
Y _____
Estab. By _____
Agency

Signature

Don Gresdal

Title

PLS

Division

Headquarters

Date

6/19/02

FS-7100-52 (3/68)

CORNER RECORD (PERPETUATION)

MONUMENT: DESCRIBE NEW MONUMENT SET, OR WORK DONE TO PRESERVE EXISTING MONUMENT

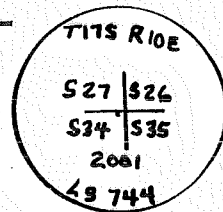

SET 2" IRON PIPE WITH 2 1/2" BRASS CAP AND SCRIBED BEARING TREES AS FOLLOWS:

10" WHITE FIR N69°20'E, 9⁰ FT. SCRIBED T17S R10E S26 BT

7" " " S37°36'W, 21⁰ FT. " T17S R10E S34 BT

6" LODGEPOLE PINE S50°52'E, 29¹/₂ FT. " T17S R10E S35 BT

7" " " N84°00'W, 26¹/₂ FT. " T17S R10E S27 BT

PRESERVE EXISTING EVIDENCE

MEASURED TO CENTER OF TREE AT ROOT CROWN. A BRASS DISC STAMPED "49 744" IS NAILED IN LOWER BLAZE.

BEARINGS ARE TRUE, BASED ON A SOLAR OBSERVATION

Work Done By Don Goodal Title PLS Date 6/19/02 State Registration No. 7CK1
or Agency

Certified Cor. Record Prepared? Yes No Filed At: Deer. Co. Date _____

G.L.O. SURVEY OF 1879 BY THOMPSON, WELDRUM & MOORE

SET WOODEN POST FOR SECTION CORNER
SCRIBED BEARING TREES FOR REFERENCE:

- 40" PINE N50°E 9 LINKS
- 40" " N50°W 15 LINKS
- 7" FIR S11°W 49 LINKS
- 6" FIR S57°E 32 LINKS

Index File No. 1771 T. R. M. Tract or Surv. No. Cor. V-17

Index File No. 1971

CORNER RECORD (SEARCH)
(Ref. FSM 7151.4)

Tract or Survey No. _____
Cor. No. V-19

T 17 S. R. 10 E. R.D. BEND County DESCHUTES S/4 S. 26
Merid. WM N.F. DNF State OR

CORNER DIAGRAM

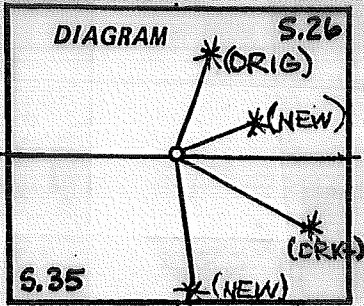

DESCRIBE CORNER MONUMENT FOUND

SF/NF

DESCRIBE BEARING TREES OR OTHER OFFICIAL ACCESSORIES FOUND

- 1) 19" by 4 ft. high stump with healed over low scar, which I opened to find a scribed BT, in the SE location.
- 2) 23" stump with a scribed T in the low blaze position, in the NE location.

PHOTO IDENTIFICATION DATA

Photo No. _____
Filed At _____
Object Ident. _____
Ident. By _____
Signature

DESCRIBE CORNER LOCATION RELATIVE TO NEAR-BY FEATURES, ALSO HOW TO REACH CORNER

PLANE COORDINATE POSITION DATA

State _____ Zone _____
X _____
Y _____
Estab. By _____
Agency

Signature Walt Miller Title PLS Division CS Headquarters SO Date 12/06
7100-52-(3,68)

CORNER RECORD (PERPETUATION)

MONUMENT: DESCRIBE NEW MONUMENT SET, OR WORK DONE TO PRESERVE EXISTING MONUMENT

I set A 2½" X 30" Aluminum Pipe Aluminum Cap rising 4" using a dist.-dist. intersect, from which:

A 10" Ponderosa Pine bears N65°E at 12.55 ft., to a 60-Penny spike in the SSE base, marked 1/4S26BT.

ACCESS An 11" Ponderosa Pine bears S06°E at 51.0 ft., to a 60-Penny spike in the W base, marked 1/4S35BT.

RESULTING DATA TO ORIGINAL B.T.'S:

- 1) S68°E at 42.9 ft. to 4 ft. high stump.
- 2) N18½°E at 21.8 ft. to 23" stump.

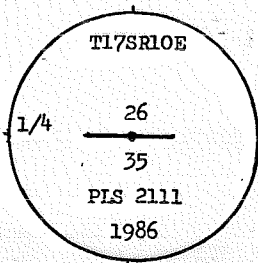

9
G EVIDENCE

Work Done By Walt Miller Title PLS Date 12/86 State Registration No. or Agency 2111 10

Certified Cor. Record Prepared? Yes No Filed At: Des. Co. Date 12/18/86 11

REMARKS

Set post for 1/4 Sec. corner from which:

A pine 9 in diam bears N 17° E 33 lks dist
 A pine 12 " " " S 72° E 65 " "

Index File No. 1971 T. 17 R. 10 M. Tract or Surv. No. Cor. V-1 12
 13

Index
File No. 1971

CORNER RECORD (SEARCH)
(Ref. FSM 7151.4)

Tract or
Survey No. _____
Cor. No. V-19

T 17 S. R. 10 E. R.D. BEND County DESCHUTES S/4 S. 26

Merid. WM N.F. DNF State OR

CORNER DIAGRAM

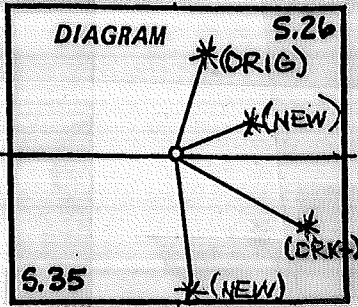

DESCRIBE CORNER MONUMENT FOUND

SF/NF

DESCRIBE BEARING TREES OR OTHER OFFICIAL ACCESSORIES FOUND

- 1) 19" by 4 ft. high stump with healed over low scar, which I opened to find a scribed BT, in the SE location.
- 2) 23" stump with a scribed T in the low blaze position, in the NE location.

PHOTO IDENTIFICATION DATA

Photo No. _____
Filed At. _____
Object Ident. _____
Ident. By _____
Signature

DESCRIBE CORNER LOCATION RELATIVE TO NEAR-BY FEATURES, ALSO HOW TO REACH CORNER

PLANE COORDINATE POSITION DATA

State _____ Zone _____
X _____
Y _____
Estab. By _____
Agency

Signature <u>Walt Miller</u>	Title <u>PLS</u>	Division <u>CS</u>	Headquarters <u>SO</u>	Date <u>12/06</u>	7100-52-(3,68)
---------------------------------	---------------------	-----------------------	---------------------------	----------------------	----------------

CORNER RECORD (PERPETUATION)

MONUMENT: DESCRIBE NEW MONUMENT SET, OR WORK DONE TO PRESERVE EXISTING MONUMENT

I set A 2½" X 30" Aluminum Pipe Aluminum Cap rising 4" using a dist.-dist. intersect, from which:

A 10" Ponderosa Pine bears N65°E at 12.55 ft., to a 60-Penny spike in the SSE base, marked 1/4S26BT.

ACCESS An 11" Ponderosa Pine bears S06°E at 51.0 ft., to a 60-Penny spike in the W base, marked 1/4S35BT.

RESULTING DATA TO ORIGINAL B.T.'S:

- 1) S68°E at 42.9 ft. to 4 ft. high stump.
- 2) N18½°E at 21.8 ft. to 23" stump.

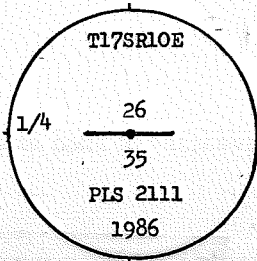

EVIDENCE

Work Done By Walt Miller Title PLS Date 12/86 State Registration No. 2111
or Agency

Certified Cor. Record Prepared? Yes No Filed At: Des. Co. Date 12/18/86

REMARKS

Set post for 1/4 Sec. corner from which:

A pine 9 in diam bears N 17° E 33 lks dist

A pine 12 " " " S 72° E 65 " "

Index File No. 1971 T. 17 R. 10 M.

Tract or Surv. No.

Cor. V-19

12

13

USDA-FOREST SERVICE

Index
File No. **2571**

CORNER RECORD (SEARCH)
(Ref. FSM 7.151.4)

Tract or
Survey No.

Cor.
No. **V-25**

T. **17** S. R. **10** E. R.D. **BEND** County **DESCHUTES** **SE** COR. of SEC. **25**
Merid. **WILLAMETTE** N.F. **DESCHUTES** State **OREGON** COR. of SEC.

CORNER DIAGRAM PER LEGEND

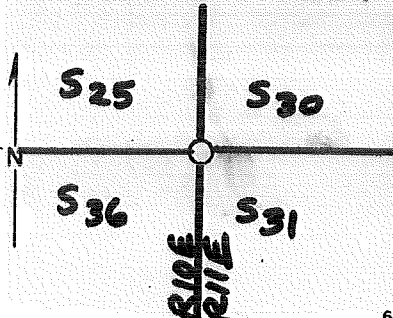

DESCRIBE CORNER MONUMENT FOUND

SF/NF

DESCRIBE BEARING TREES OR OTHER OFFICIAL ACCESSORIES FOUND

SF/NF -

**ALUM. POSTER APPROX. COR. KNITTING NEEDLE
IN SMALL STONE MOUND APPROX 05 FT. FROM
POSTER TREE.**

PHOTO IDENTIFICATION DATA

Photo No. _____
Filed At. _____
Object Ident. _____
Ident. By _____
Signature

DESCRIBE CORNER LOCATION RELATIVE TO NEAR-BY FEATURES, ALSO HOW TO REACH CORNER

Corner Legend:

- Searched for/Not Found
- Evidence Found/Accept
- Permanent Monument

Signature **MJH/HCP**

Title **ST**

Division **50**

Headquarters **BEND**

Date **5/81**

D-7100-52 (3/79)

CORNER RECORD (PERPETUATION)

MONUMENT. DESCRIBE NEW MONUMENT SET, OR WORK DONE TO PRESERVE EXISTING MONUMENT

MONUMENT STAFFED

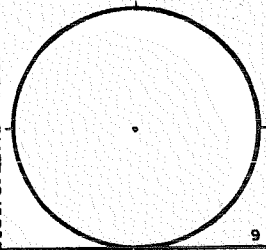

9

ACCESSORIES. DESCRIBE NEW BT'S, WITNESS OBJECTS ETC. ESTABLISHED, OR WORK DONE TO PRESERVE EXISTING EVIDENCE

10

Work Done By _____ Title _____ Date _____ State Registration No. or Agency _____

PLAT PREPARED OR Certified Cor. Record Prepared? Yes No Filed At: Co. SURVEYOR'S OFFICE Date _____

11

REMARKS

Index File No. _____ T. S., R. E., W. M. Tract or Surv. No. _____ Cor. _____

12

13

Index File No. 0973

CORNER RECORD (SEARCH) Contract or Survey No. _____
(Ref. FSM 7151.4)

Cor. No. X-09

T 17 S. R. 10 E. R.D. BEND

County DESCHUTES

Cor. of Section 33

Merid. Willamette

N.F. Deschutes

State Oregon

Section 33

CORNER DIAGRAM per legend

DESCRIBE CORNER MONUMENT FOUND

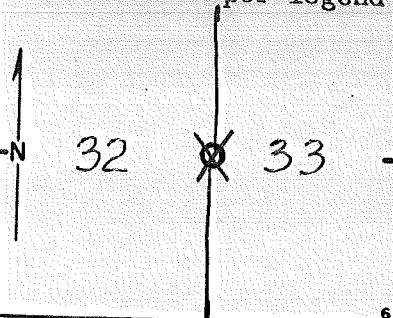

DESCRIBE BEARING TREES OR OTHER OFFICIAL ACCESSORIES FOUND

DOWN 10" LOG (SEEMS TO BE S 81° W TREE) (BT S)

ROOT HOLE 2' FROM LOG?

(BT TAG ON LOG)

PHOTO IDENTIFICATION DATA

Photo No. _____
Filed At. _____
Object Ident. _____
Ident. By _____
Signature

DESCRIBE CORNER LOCATION RELATIVE TO NEAR-BY FEATURES, ALSO HOW TO REACH CORNER

CHAINED & COMPASS NORTH FROM SEC. 32/33
5/4

CORNER LEGEND:

- FS or Unverified
- Contr. Other
- Searched For/Not Found
- Evidence Found/Accept.
- Permanent Mon. Set/Fd.

Searched By S. CHAMBERLIN

Title S.T. Division CS Headquarters SO

Date 6-18-84

CORNER RECORD (PERPETUATION)

MONUMENT: DESCRIBE NEW MONUMENT SET, OR WORK DONE TO PRESERVE EXISTING MONUMENT

Three horizontal lines for describing the monument.

MONUMENT STAMPED

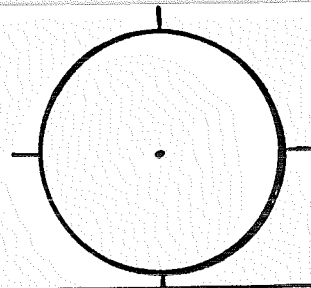

ACCESSORIES : DESCRIBE NEW BT'S WITNESS OBJECTS ETC. ESTABLISHED, OR WORK DONE TO PRESERVE EXISTING EVIDENCE

Three horizontal lines for describing accessories.

Work Done By _____ Title _____ Date _____ State Registration No. or Agency _____

Plat or Certified Cor. Record Prepared? Yes No Filed At: _____ Co. Surveyor's Office Date _____

History of Surveys, G.L.O., etc.

9" PINE EAST @ 10 ⁵
7" " S 81° W @ 17 ²

Index File No.

0423 T. 17 S., R. 10 E., W.M.

Contract or Surv. No.

Cor. X-09

Index File No. 1373

CORNER RECORD (SEARCH) Contract or Survey No. (Ref. FSM 7151.4)

Cor. No. X-13

T 17 S. R. 10 E. R.D. BEND

County DESCHUTES

W/4 Cor. of

Merid. Willamette

N.F. Deschutes

State Oregon

Section 34

CORNER DIAGRAM per legend

DESCRIBE CORNER MONUMENT FOUND

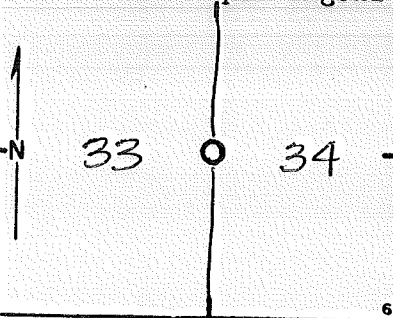

S.F.N.F.

DESCRIBE BEARING TREES OR OTHER OFFICIAL ACCESSORIES FOUND

HEAVY LOGGING ACTIVITY; CAT PILES

PHOTO IDENTIFICATION DATA

Photo No. _____
Filed At. _____
Object Ident. _____
Ident. By _____
Signature

DESCRIBE CORNER LOCATION RELATIVE TO NEAR-BY FEATURES, ALSO HOW TO REACH CORNER

CORNER LEGEND:

- FS or Unverified
- Contr. Other
- Searched For/Not Found
- Evidence Found/Accept.
- Permanent Mon. Set/Pd.

Searched By: S. CHAMBERLIN

Title ST

Division SO
CS

Headquarters SO

Date 6-13-84

CORNER RECORD (PERPETUATION)

MONUMENT: DESCRIBE NEW MONUMENT SET, OR WORK DONE TO PRESERVE EXISTING MONUMENT

MONUMENT STAMPED

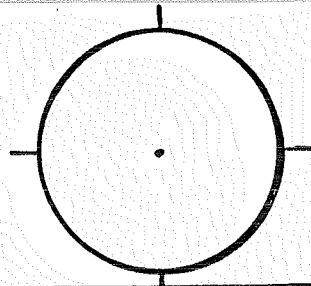

9

ACCESSORIES: DESCRIBE NEW BT's WITNESS OBJECTS ETC. ESTABLISHED, OR WORK DONE TO PRESERVE EXISTING EVIDENCE

10

Work Done By _____ Title _____ Date _____ State Registration No. or Agency _____

Plat or Certified Cor. Record Prepared? Yes No Filed At: _____ Co. Surveyor's Office Date _____

11

History of Surveys, G.L.O., etc. POST
9" PINE S45°W @ 9²
9" " EAST @ 19²

12

Index File No. 1373 T. 17 S., R. 10 E., W.M. Contract or Surv. No. _____ Cor. X-13

13

USDA-FOREST SERVICE

Index
File No. **2573**

CORNER RECORD (SEARCH)
(Ref. FSM 7.151.4)

Tract or
Survey No.

Cor.
No. **X-25**
COR. of SEC. **36**
COR. of SEC.

T. **17** S. R. **10** E. R.D. **BEND** County **DESCHUTES**
Merid. **WILLAMETTE** N.F. **DESCHUTES** State **OREGON**

E/4

CORNER DIAGRAM PER LEGEND

DESCRIBE CORNER MONUMENT FOUND

SF/NF

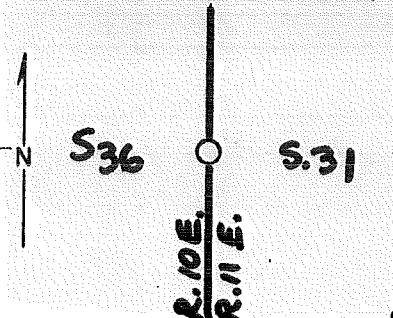

DESCRIBE BEARING TREES OR OTHER OFFICIAL ACCESSORIES FOUND

SF/NF

(ALUM. TAG APPROX. CORNER), ON STUMP, DATED 1973

PHOTO IDENTIFICATION DATA

Photo No. _____
Filed At. _____
Object Ident. _____
Ident. By _____
Signature

DESCRIBE CORNER LOCATION RELATIVE TO NEAR-BY FEATURES, ALSO HOW TO REACH CORNER

Corner Legend:

- Searched for/Not Found
- Evidence Found/Accept.
- Permanent Monument

Signature
MJH/HCP

Title

Division
S.O.

Headquarters
BEND

Date
5/81

D-7100-52 (3/79)

5

CORNER RECORD (PERPETUATION)

MONUMENT DESCRIBE NEW MONUMENT SET, OR WORK DONE TO PRESERVE EXISTING MONUMENT

MONUMENT SET AFFECTED

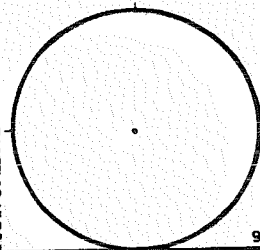

9

ACCESSORIES DESCRIBE NEW BT'S WITNESS OBJECTS ETC. ESTABLISHED, OR WORK DONE TO PRESERVE EXISTING EVIDENCE

10

Work Done By _____ Title _____ Date _____ State Registration No. _____
or Agency _____

PLAT PREPARED OR
Certified Cor. Record Prepared? Yes No Filed At: **Co. SURVEYOR'S OFFICE** Date _____

11

REMARKS

Index File No. _____ T. _____ S., R. _____ E., W. M. _____ Tract or Surv. No. _____ Cor. _____

12

13

USDA-FOREST SERVICE

Index
File No. 0375

CORNER RECORD (SEARCH)

(Ref. FSM 7.151.4)

Tract or
Survey No. _____

Cor.
No. 2-3

T. 17S S. R. 10E

R.D. BOND

County DESCHUTES

5/4

COR. of SEC. 31

Merid. WILLAMETTE

N.F. DESCHUTES

State OREGON

N/4

COR. of SEC. 6

CORNER DIAGRAM PER LEGEND

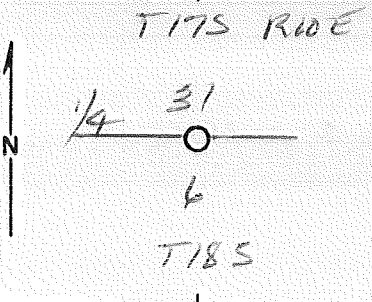

DESCRIBE CORNER MONUMENT FOUND

SF/NF

2

DESCRIBE BEARING TREES OR OTHER OFFICIAL ACCESSORIES FOUND

SF/NF

3

PHOTO IDENTIFICATION DATA

Photo No. _____
Filed At. _____
Object Ident. _____
Ident. By _____
Signature

DESCRIBE CORNER LOCATION RELATIVE TO NEAR-BY FEATURES, ALSO HOW TO REACH CORNER

1

- Corner Legend:
- Searched for/Not Found
 - Evidence Found/Accept.
 - Permanent Monument

Signature ROBERT KARL

Title LS

Division SC&S

Headquarters Bond

Date 9/17/80

D-7100-52 (3/79)

5

CORNER RECORD (PERPETUATION)

MONUMENT DESCRIBE NEW MONUMENT SET, OR WORK DONE TO PRESERVE EXISTING MONUMENT

MONUMENT STAFFED

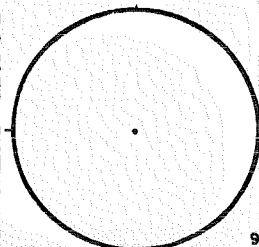

9

ACCESSORIES DESCRIBE NEW BT'S WITNESS OBJECTS ETC. ESTABLISHED, OR WORK DONE TO PRESERVE EXISTING EVIDENCE

10

Work Done By ROBERT KARL Title LS Date _____ State Registration No. 1692
or Agency _____
PLAT PREPARED OR
Certified Cor Record Prepared? Yes No Filed At: Co. SURVEYOR'S OFFICE Date _____

11

REMARKS

Index File No. 0375 T. 17 S., R. 10 E., W.M.

Tract or Surv. No.

Cor. 2-03¹²₁₃

USDA-FOREST SERVICE

Index
File No. 0575

CORNER RECORD (SEARCH)

(Ref. FSM 7151.4)

Tract or Survey No. 02211 N

Cor. No. 2
A-5

T 18S R. 10E

R.D. Bend County Deschutes

SE COR. SEC. 31

Merid. Willamette

N.F. Deschutes State Oregon

NW COR. SEC. 5

CORNER DIAGRAM

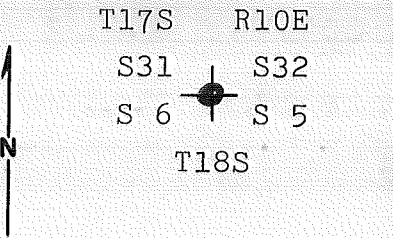

DESCRIBE CORNER MONUMENT FOUND

Original called-for post not found.

DESCRIBE BEARING TREES OR OTHER OFFICIAL ACCESSORIES FOUND

Found root holes and remains of four original bearing trees (one scribe partially visible).
N 59° E 29.8 Fd. stump hole and remains of rotten tree.
S 13° E 46.9 Fd. remains and root hole.
S 57° W 26.6 Fd. scribing "T18S R10E" S6" face down.
N 40° W 31.3 Fd. root hole and piece with axe marks.

PHOTO IDENTIFICATION DATA

Photo No. _____
Filed At. _____
Object Ident. _____
Ident. By _____
Signature

DESCRIBE CORNER LOCATION RELATIVE TO NEAR-BY FEATURES, ALSO HOW TO REACH CORNER

Corner is approx. 11 miles West of Bend, Oregon, near F.S. Road 1722.

PLANE COORDINATE POSITION DATA

State _____ Zone _____
X _____
Y _____
Estab. By _____
Agency

Signature Robert M. Kael, Title Surveyor, Division Sun Country Headquarters Eng. & Surveying, Inc. Date Bend, OR. 7100-52-(3/68)
8/21/80

†

CORNER RECORD (PERPETUATION)

MONUMENT : DESCRIBE NEW MONUMENT SET, OR WORK DONE TO PRESERVE EXISTING MONUMENT

Set 2½" x 30" galv. l. Pipe & 2½" Brass cap marked:
 (Set from original bearing trees in NE & SE quadrants)
 (used as best mean location of corner)
 Cap rises 8" above ground.

T17S	R10E
S31	S32
S 6	S 5
T18S	
LS 1642	
1980	

9

ACCESSORIES : DESCRIBE NEW BT's WITNESS OBJECTS ETC. ESTABLISHED, OR WORK DONE TO PRESERVE EXISTING EVIDENCE

Scribed four new bearing trees:

- A 7" L.P. Pine bears N 21° E 24.0' scribed "T17S R10E S32, BT"
- A 7" L.P. Pine bears S 75° E 30.2' scribed "T18S R10E S 5, BT"
- A 9" L.P. Pine bears S 47° W 21.6' scribed "T18S R10E S 6, BT"
- A 7" L.P. Pine bears N 43° W 48.6' scribed "T17S R10E S31, BT"

10

Work Done By Robt. M. Karl Title Land Surveyor Date 8/11/80 State Registration No. 1642
 or Agency _____

Certified Cor. Record Prepared? Yes No

Filed At: _____

Date _____

11

REGISTERED

**PROFESSIONAL
LAND SURVEYOR**

Robert M. Karl

OREGON
JULY 14, 1978
ROBERT M. KARL
1642

REMARKS

Index File No. 0575 T. 17 S. R. 10 E W. M.

Tract or Surv. No. _____

Cor. 2-053
 U.S. G.P.O. 1977-725-5767-986

2-5 12

USDA-FOREST SERVICE

Index
File No. 0775

CORNER RECORD (SEARCH)
(Ref. FSM 7.151.4)

Tract or
Survey No. 022114 Cor.
No. 2-7

T. 17S S. R. 10E E. R.D. 13E701D County DESCHUTES 5/4 COR. of SEC. 32

Merid. WILLAMETTE N.F. DESCHUTES State OREGON N/A COR. of SEC. 5

CORNER DIAGRAM PER LEGEND

DESCRIBE CORNER MONUMENT FOUND

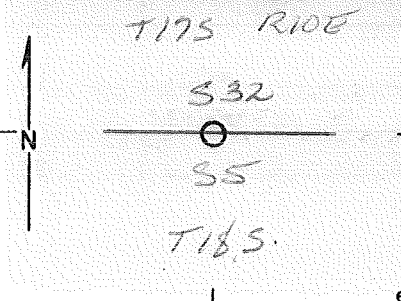

SEARCH FOR, NOT FOUND

DESCRIBE BEARING TREES OR OTHER OFFICIAL ACCESSORIES FOUND

SF/NF

PHOTO IDENTIFICATION DATA

Photo No. _____
Filed At. _____
Object Ident. _____
Ident. By _____
Signature

DESCRIBE CORNER LOCATION RELATIVE TO NEAR-BY FEATURES, ALSO HOW TO REACH CORNER

Corner Legend:

- Searched for/Not Found
- Evidence Found/Accept
- Permanent Monument

Signature ROBERT KARI Title LS Division SC&AS Headquarters _____ Date 9/1/80 10/1/80
D-7100-52 (3/79)

CORNER RECORD (PERPETUATION)

MONUMENT. DESCRIBE NEW MONUMENT SET, OR WORK DONE TO PRESERVE EXISTING MONUMENT

MONUMENT STAMPED

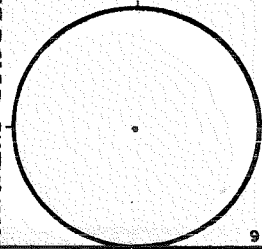

ACCESSORIES. DESCRIBE NEW B^T'S WITNESS OBJECTS ETC. ESTABLISHED, OR WORK DONE TO PRESERVE EXISTING EVIDENCE

Work Done By R.M. KARL Title 25 Date _____ State Registration No. 1600
PLAT PREPARED OR
Certified Cor. Record Prepared? Yes No Filed At: **Co. SURVEYOR'S OFFICE** Date _____

REMARKS

Index File No. 0775 T. 17 S., R. 10 E., W.M. Tract or Surv. No. _____ Cor. 2-7
2-07

Index
File No. 0975

CORNER RECORD (SEARCH) Contract or
(Ref. FSM 7151.4) Survey No.

17 S. R. 10 E. R.D. BEND

Merid. Willamette N.F. Deschutes County DESCHUTES State Oregon

Cor. No.

SE
Section

CORNER DIAGRAM per legend

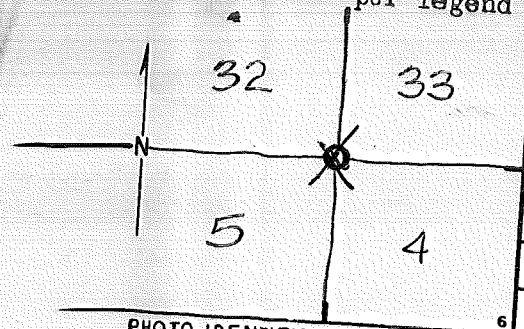

DESCRIBE CORNER MONUMENT FOUND

STONE 14 X 8 X 8
4 NOTCHES ON WEST AND 1 NOTCH

DESCRIBE BEARING TREES OR OTHER OFFICIAL ACCESSORIES FOUND

DOWN LOG N56°E @ 40° T16SR10E S33 BT

PHOTO IDENTIFICATION DATA

Photo No. _____
Filed At. _____
Object Ident. _____
Ident. By _____

Signature _____

DESCRIBE CORNER LOCATION RELATIVE TO NEAR-BY FEATURES, ALSO HOW TO REACH

NO NOTES

600' EAST OF BOARD

CORNER LEGEND:

- S or Unverified
- Contr. Other
- Searched For/Not Found
- Evidence Found/Accept.
- Permanent Mon. Set/Fd.
- Permanent Mon. Set/Fd.

Searched By: S. CHAMBERLIN

Title S.T. Division CS Headquarters SO

Date 6-14-84

CORNER RECORD (PERPETUATION)

MONUMENTS DESCRIBE NEW MONUMENT SET, OR WORK DONE TO PRESERVE EXISTING MONUMENT

MONUMENT STAMPED

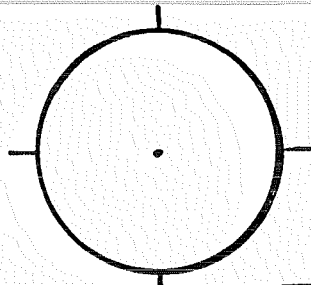

ACCESSORIES DESCRIBE NEW BT'S WITNESS OBJECTS ETC. ESTABLISHED, OR WORK DONE TO PRESERVE EXISTING EVIDENCE

Work Done By _____ Title _____ Date _____ State Registration No. _____
or Agency _____
Plat or _____
Certified Cor. Record Prepared? Yes No Filed At: _____ Co. Surveyor's Office Date _____

History
of
Surveys,
G.L.O.,
etc.

Index File No. 0975

T. 17 S., R. 10 E., W.M.

Contract or Surv. No.

Cor. 2-09

USDA-FOREST SERVICE

Index-
File No. 0975

CORNER RECORD (SEARCH)

(Ref. FSM 7151.4)

Tract or
Survey No. 02211N

Cor. 2-09
No. 40

T 18S 175 R. 10E

R.D. Bend County Deschutes

Merid. Willamette

N.F. Deschutes State Oregon

SE C. & R. SEC. 32
NW COR. SEC. 4

CORNER DIAGRAM

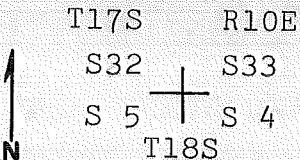

DESCRIBE CORNER MONUMENT FOUND

Original called-for post not found.

DESCRIBE BEARING TREES OR OTHER OFFICIAL ACCESSORIES FOUND

Found remains of two original bearing trees:
A stump and remains bears N 25°W 9.3'
(scribe partially visible)

Remains of stump bears S 32° W 8° (No scribing visible)
Piece of scribe fd. S 55° E 347' from true corner
location (believed to have been transported to this
location).

PHOTO IDENTIFICATION DATA

Photo No. _____
Filed At. _____
Object Ident. _____
Ident. By _____

Signature

DESCRIBE CORNER LOCATION RELATIVE TO NEAR-BY FEATURES, ALSO HOW TO REACH CORNER

Corner is approx. 11 miles West of Bend, Ore.
near F.S. Road #1722

PLANE COORDINATE POSITION DATA

State _____ Zone _____
X _____
Y _____
Estab. By _____

Agency

Signature

Title

Division

Headquarters

Date

Robert M. Karl Surveyor, Sun Country Eng. & Surveying, Inc. Bend, OR

7100-52-13/68

8/21/80

T
CORNER RECORD (PERPETUATION)

MONUMENT: DESCRIBE NEW MONUMENT SET, OR WORK DONE TO PRESERVE EXISTING MONUMENT

Set 2½" G.I.P. & 2½" Brass Cap marked:
Set cap from original B.T. in Sec. 32
Cap rises 4" above ground

T17S R10E
S32 + S33
S 5 + S 4
T18S
LS 1642
1980

9

ACCESSORIES : DESCRIBE NEW BT'S WITNESS OBJECTS ETC. ESTABLISHED, OR WORK DONE TO PRESERVE EXISTING EVIDENCE

Scribed four new bearing trees:

A 7" L.P. Pine bears N 49°E 23⁰⁰ scribed "T17S R10E S33, BT"
An 8" L.P. Pine bears S 84°E 35⁶ scribed "T18S R10E S4, BT"
A 7" L.P. Pine bears S 54°W 12⁰⁰ scribed "T18S R10E S5, BT"
A 6" L.P. Pine bears N 50°W 36⁰⁰ scribed "T17S R10E S32, BT"

10

Work Done By: Robert M. Karl Title Land Surveyor Date 8-13-80 State Registration No. 1642
or Agency

Certified Cor. Record Prepared Yes No

Filed At:

Date

11

REGISTERED
PROFESSIONAL
LAND SURVEYOR

REMARKS

OREGON
JULY 14, 1978
ROBERT M. KARL
1642

29

12

Index File No. 0975 T. 17S R. 10 ENM.

Tract or Surv. No.

Cor. 2-09 13
U.S. G.P.O. 1977-725-576/586

USDA-FOREST SERVICE

Index

File No. 1175

CORNER RECORD (SEARCH)

(Ref. FSM 7151.4)

Tract or Survey No. 02211N

Cor. No. 3-11

T 18S17S R. 10E

R.D. Bend

County Deschutes

S/4 Cor. Sec. 33

Merid. Willamette

N.F. Deschutes

State Oregon

N/4 Cor. Sec. 9

CORNER DIAGRAM

T 17S R 10E



S 33

1/4

S 4

T 18S

LS 1642

1980

DESCRIBE CORNER MONUMENT FOUND

Original called-for post not found.

DESCRIBE BEARING TREES OR OTHER OFFICIAL ACCESSORIES FOUND

No original bearing trees found.

PHOTO IDENTIFICATION DATA

Photo No. _____

Filed At. _____

Object Ident. _____

Ident. By _____

Signature

PLANE COORDINATE POSITION DATA

State _____ Zone _____

X _____

Y _____

Estab. By _____

Agency

DESCRIBE CORNER LOCATION RELATIVE TO NEAR-BY FEATURES, ALSO HOW TO REACH CORNER

Corner is + 11 1/2 miles West of Bend, Oregon. near F.S. Road # 1722.

Signature

Surveyor, Robert McNeil

Title

SCE&S Division

Headquarters

Bend,

Date

7100-52 (3.68)

CORNER RECORD (PERPETUATION)

MONUMENT : DESCRIBE NEW MONUMENT SET, OR WORK DONE TO PRESERVE EXISTING MONUMENT T 17S R 10E

Set 2 1/2" x 30" G.I.P. & 2 1/2" Brass Cap Marked:

(Set by single proportionate measure)

1/4 S33
S 4
T 18S
LS 1642
1980

ACCESSORIES : DESCRIBE NEW BT'S WITNESS OBJECTS ETC. ESTABLISHED, OR WORK DONE TO PRESERVE EXISTING EVIDENCE

Scribed 2 new bearing trees:

A 7" L.P. Pine bears S 55° W 24⁶/₈, scribed "1/4 S 4, BT"

A 7" L.P. Pine bears N 02° E 20⁸/₈, scribed "1/4 S 33, BT"

Work Done By Robert M. Karl Title Land Surveyor Date 9/4/80 State Registration No. 1642 Ore.
or Agency

Certified Cor. Record Prepared ? Yes No Filed At: _____ Date _____

**REGISTERED
PROFESSIONAL
LAND SURVEYOR**

Robert M. Karl

OREGON
JULY 14, 1978
ROBERT M. KARL

Index File No. 1642 T

REMARKS

1175 17S. 10EW.

Tract or Surv. No.

Cor. 2-11 12

2-11 13

Index
File No. 1375

CORNER RECORD (SEARCH) Contract or
(Ref. FSM 7151.4) Survey No. Cor. No. 2-13

T 17 S. R. 10 E. R.D. Bend County Deschutes SW Cor. of

Merid. WILLAMETTE N.F. DESCHUTES State OREGON Section 34

SEE: A-13 T. 18 S., R. 10 E., W.M.

BCSP



USDA-FOREST SERVICE

Index

File No. 1475

CORNER RECORD (SEARCH)

(Ref. FSM 7151.4)

Tract or

Survey No. 02211N

Cor. 2-14
No. 4-14

T 18S R. 10E

R.D. Bend

County Deschutes

W/16 Cor. 1
SEC. 34 & 3

Merid. Willamette

N.F. Deschutes

State Bend

CORNER DIAGRAM

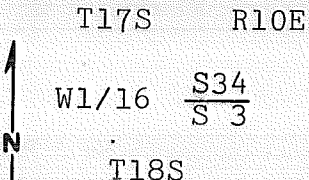

DESCRIBE CORNER MONUMENT FOUND

No original monument set

DESCRIBE BEARING TREES OR OTHER OFFICIAL ACCESSORIES FOUND

None

PHOTO IDENTIFICATION DATA

Photo No. _____

Filed At. _____

Object Ident. _____

Ident. By _____

Signature

PLANE COORDINATE POSITION DATA

State _____ Zone _____

X _____

Y _____

Estab. By _____

Agency

DESCRIBE CORNER LOCATION RELATIVE TO NEAR-BY FEATURES, ALSO HOW TO REACH CORNER

Corner is \pm 10 miles West of Bend, Oregon near F.S. Road #1750.

Robert M. Karl
Signature

Title
Surveyor

Division
SCE&S

Headquarters
Bend, OR

Date
8/21/80

7100-52 (3, 68)

CORNER RECORD (PERPETUATION)

MONUMENT : DESCRIBE NEW MONUMENT SET, OR WORK DONE TO PRESERVE EXISTING MONUMENT

Set 2 1/2" x 30" G.I.P. & 2 1/2 Brass Cap marked:

T17S R10E
W1/16 S34
S3
T18S
LS 1642
1980

ACCESSORIES : DESCRIBE NEW BT'S WITNESS OBJECTS ETC. ESTABLISHED, OR WORK DONE TO PRESERVE EXISTING EVIDENCE

2 Bearing Trees scribed:

A 10" White Fir bears N 50° E 18.4' scribed "W1/16 S34 BT"

A 10" L.P. Pine bears S 20° E 38.0' scribed "W1/16 S3 BT"

Work Done By Robert M. Karl Title Land Surveyor Date 8/15/80 State Registration No. 1642
or Agency

Certified Cor Record Prepared? Yes No Filed At: Date

REGISTERED
PROFESSIONAL
LAND SURVEYOR

Robert M. Karl

OREGON
JULY 14, 1978
ROBERT M. KARL
1642

REMARKS

Index File No. 1975 T. 17S. R. 10 S.W. M.

Tract or Surv. No.

Cor. 2-14 13

US DA-FOREST SERVICE

Index
File No. 1575

CORNER RECORD (SEARCH)
(Ref. FSM 7151.4)

Tract or
Survey No. 02211N

Cor.
No. A-15

T 18S77S R. 10E

R.D. Bend County Deschutes

S/4 COR. SEC. 34

Merid. Willamette

N.F. Deschutes State Oregon

N/4 COR. SEC. 3

CORNER DIAGRAM

DESCRIBE CORNER MONUMENT FOUND

Original called for post not found.

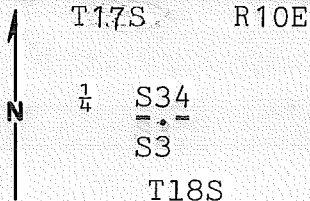

DESCRIBE BEARING TREES OR OTHER OFFICIAL ACCESSORIES FOUND

Found one original bearing tree, a 26" Ponderosa Pine bears N4°W 38.3'. Scribe visible (upper blaze previously opened to reveal "S"-lower blaze unopened)

PHOTO IDENTIFICATION DATA

Photo No. _____
Filed At. _____
Object Ident. _____
Ident. By _____
Signature

DESCRIBE CORNER LOCATION RELATIVE TO NEAR-BY FEATURES, ALSO HOW TO REACH CORNER

Corner is approximately 9 miles west of Bend, Ore. near F.S. Road No. 1750

PLANE COORDINATE POSITION DATA

State _____ Zone _____
X _____
Y _____
Estab. By _____
Agency

Signature

Title

Division

Headquarters

Date

7100-52-(3/68)

Robert M. Karl

Surveyor S.C.E. & S.

Bend

8/21/80

T
CORNER RECORD (PERPETUATION)

MONUMENT: DESCRIBE NEW MONUMENT SET, OR WORK DONE TO PRESERVE EXISTING MONUMENT

Set 2 1/2" X 30" Galv. 1. pipe & 2 1/2" brass cap marked:
Rising 5" above ground.
Placed stone mound around cap

T17S R10E
1/4 S34
S3
PLS T18S
1642
1980

9

ACCESSORIES : DESCRIBE NEW BT'S WITNESS OBJECTS ETC. ESTABLISHED, OR WORK DONE TO PRESERVE EXISTING EVIDENCE

Scribed two new bearing trees:

A 7" Ponderosa Pine bears S 48° E 28.9' scribed "1/4 S 3 BT"
A 7" Ponderosa Pine bears N 44° E 47.0' scribed "1/4 S 34 BT"

10

Work Done By: Robert M. Karl Title Land Surveyor Date 7/22/80 State Registration No. 1642
or Agency

Certified Cor Record Prepared? Yes No Filed At: _____ Date _____ 11

REGISTERED
PROFESSIONAL
LAND SURVEYOR
Robert M. Karl
OREGON
JULY 14, 1978
ROBERT M. KARL
1642

REMARKS

Index Pile No. 1575 T. 17S. R. 10E.W. M.

Tract or Surv. No.

Cor 2-15 13
U.S. G.P.O. 1977-725-576/586

US DA-FOREST SERVICE

Index
File No. 0175

CORNER RECORD (SEARCH)
(Ref. FSM 7151.4)

Tract or
Survey No. 02211N Cor. 2
No. A-1

T 18S R. 10E

R.D. Bend County Deschutes

Merid. Willamette

N.F. Deschutes State Oregon

SW COR. SEC. 31
NE COR. SEC. 1

CORNER DIAGRAM

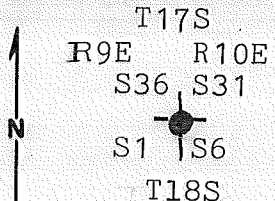

DESCRIBE CORNER MONUMENT FOUND

Original called - for post not found.

DESCRIBE BEARING TREES OR OTHER OFFICIAL ACCESSORIES FOUND

Found one original bearing tree dead & down (stump still in place) N 32° E 5.3'
Scribed "R10E, S 31"

PHOTO IDENTIFICATION DATA

Photo No. _____
Filed At. _____
Object Ident. _____
Ident. By _____
Signature

DESCRIBE CORNER LOCATION RELATIVE TO NEAR-BY FEATURES, ALSO HOW TO REACH CORNER

Corner is approx. 12 miles west of Bend, Ore.
Near F.S. Road No. 1722.

PLANE COORDINATE POSITION DATA

State _____ Zone _____
X _____
Y _____
Estab. By _____
Agency

Signature

Robert M. Karl

Title
Surveyor

Division
S.C.E. & S.

Headquarters
Bend

Date
8/21/80

7100-52-(3/68)

T

CORNER RECORD (PERPETUATION)

MONUMENT: DESCRIBE NEW MONUMENT SET, OR WORK DONE TO PRESERVE EXISTING MONUMENT

Set 2 1/2" X 30" Alum. pipe & 2 1/2" alum. cap marked:

No stone available for mound

Cap rises 4" above ground

T17S
R9E S36 S31 R10E
S1 S6
T18S
PLS 1642
1980

9

ACCESSORIES : DESCRIBE NEW BT'S WITNESS OBJECTS ETC. ESTABLISHED, OR WORK DONE TO PRESERVE EXISTING EVIDENCE

Scribed 4 new bearing trees:

- A 10" L.P. Pine bears N 55° E 21.6' Scribed: "T 17 S, R 10 E, S 31 BT"
- A 12" L.P. Pine bears S 38° E 60.3' Scribed: "T 18 S, R 10 E, S 6 BT"
- A 8" Mtn Hemlk bears S 35° W 25.4' Scribed: "T 18 S, R 9 E, S 1 BT"
- A 11" L.P. Pine bears N 14° W 14.5' Scribed: "T 17 S, R 9 E, S 36 BT"

10

Work Done By Robt. M. Karl Title Land Surveyor Date 7/15/80 State Registration No. 1642
or Agency _____

Certified Cor. Record Prepared Yes No Filed At: _____ Date _____

11

**REGISTERED
PROFESSIONAL
LAND SURVEYOR**

REMARKS

Robert M. Karl

OREGON
JULY 14, 1978
ROBERT M. KARL
1642

Index File No. 0175 T. 17 S R. 10 E W. M. Tract or Surv. No. _____ U.S. G.P.O. 1977-26-540-586 Cor. 2-01 13

2-1 12

Index
File No. 1775

CORNER RECORD (SEARCH)
(Ref. FSM 7151.4)

Tract or
Survey No. _____

Cor.
No. 2-17

T 17 S. R. 10 E. R.D. BEND County DESCHUTES SW COR. SEC. 35

Merid. WILLAMETTE N.F. DESCHUTES State OREGON NE COR. SEC. 3

SEE: A-17
T 18S R 10E

SF/NF

index File No. <u>1775</u>	CORNER RECORD (SEARCH) (Ref. FSM 7151.4)	Tract or Survey No. _____	Cor. No. <u>Z-17</u>
T <u>17</u> S. R. <u>10</u> E. R.D. <u>BEND</u>	County <u>DESCHUTES</u>	SW COR. SEC. 35	
Merid. <u>WILLAMETTE</u> N.F. <u>DESCHUTES</u>	State <u>OREGON</u>	NE COR. SEC. 3	

SEE: A-17
T 18S R 10E

SF/NF

Index
File No. 1975
T 17 S. R. 10 E. R.D. BEND
Merid. WILLAMETTE N.F. DESCHUTES

CORNER RECORD (SEARCH)
(Ref. FSM 7151.4)

Tract or
Survey No. _____

Cor.
No. 2-19
1/4 COR. SEC. 35
N/4 COR. SEC. 2,

County DESCHUTES
State OREGON

SEE: A-19

T185 R10E

SF/NF

Index File No. <u>2175</u>	CORNER RECORD (SEARCH) (Ref. FSM 7151.4)	Tract or Survey No. _____	Cor. No. <u>Z-21</u>
T <u>17</u> S. R. <u>10</u> E.	R.D. <u>BEND</u>	County <u>DESCHUTES</u>	<u>SE COR SEC. 35</u>
Merid. <u>WILLAMETTE</u>	N.F. <u>DESCHUTES</u>	State <u>OREGON</u>	<u>NEW COR. SEC. 1</u>

SEE: A-21

T 185 R10E

SF/NF

Index
File No. 2375

CORNER RECORD (SEARCH)
(Ref. FSM 7151.4)

Tract or
Survey No. _____
Cor. No. Z-23

T 17 S. R. 10 E. R.D. BEND County DESCHUTES SH OR.S.36
Merid. WILLAMETTE N.F. DESCHUTES State OREGON

SEE: T.18 S. - R.10 E.

A-23

B.C.

S36

T.17S.
T.18S.

S1

R.10 E.

Index
File No. 2575 CORNER RECORD (SEARCH) (Ref. FSM 7151.4) Tract or Survey No. Cor. No. Z-25
T 17 S. R. 10 E. R.D. BEND County DESCHUTES SE COR SEC. 36
Merid. WILLAMETTE N.F. DESCHUTES State OREGON

SEE: T. 18 S. - R. 10 E.

A-25

B.C.